

bartons 
FOR YOUR NEXT MOVE...

Worksop Road, Woodsetts



Guide Price £100,000 to £105,000 - This ground floor two bedroom flat is located within the semi-rural village of Woodsetts which provides bus routes to Worksop and Rotherham. Although it needs a little TLC it does provide easy to run and easy to maintain accommodation comprising: Communal Entrance Hall, Open Plan Lounge Dining Room, Kitchen, two double bedrooms and a bathroom with separate Shower. Externally it has a shared rear garden patio area and to the front there is allocated parking. Council Tax Band: A, Tenure: Leasehold, EPC to Follow

www.bartons-net.co.uk



ACCOMMODATION

- Two Bedroom Ground Floor Apartment
- In needs a little TLC but spacious Internally
- Communal Hallway, OPEN PLAN Lounge / Dining Room
- Fitted Kitchen, Two Double Bedrooms
- Bathroom with Separate Shower
- Communal rear patio Area and Allocated Parking to the Front
- Pleasant Village Location within easy Reach of Worksop



GROUND FLOOR
723 sq.ft. (67.2 sq.m.) approx.

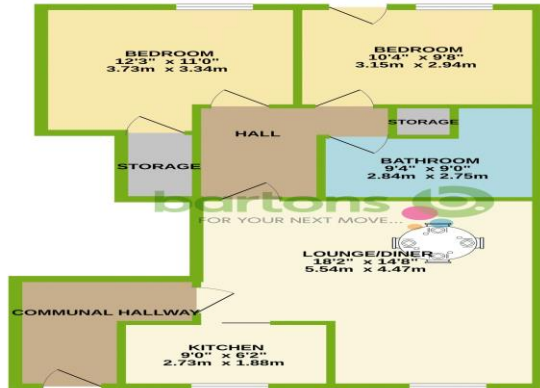

TOTAL FLOOR AREA: 723 sq.ft. (67.2 sq.m.) approx.
While every attempt has been made to ensure the accuracy of the information contained herein, measurements are taken from the floor to ceiling and are not intended to be used for any purpose other than to provide a general indication of the size of the property. The floor area is for information only and should not be used as a basis for any legal proceedings. The floor area is for information only and should not be used as a basis for any legal proceedings. The floor area is for information only and should not be used as a basis for any legal proceedings.



bartons **b.**
FOR YOUR NEXT MOVE...

51-53 Moorgate Street, Rotherham, South Yorkshire, S60 2EY
T: 01709 515740 E: info@bartons-net.co.uk

