



Heather Close, MOORGATE



This impressive FOUR double bedroom detached property has been SIGNIFICANTLY EXTENDED to both the side and rear providing generous family sized living accommodation. It is situated in a quiet cul de sac position which is within easy reach of ROTHERHAM HOSPITAL, Thomas Rotherham College, Town and handy for commuter transport links for the M1 and M18 motorway networks. It is appointed with a high specification throughout and briefly comprises of three reception rooms, the front with a bay window, the rear with a further bay window and feature corner wood burning stove, has a stylish modern fitted Kitchen with a rear Utility extension in a gloss finish with extensive integral appliances, fully fitted STUDY, downstairs WC, FOUR DOUBLE BEDROOMS, all with built-in storage / wardrobes, two with en-suite Shower Rooms and there is an extra modern Family Bathroom. Externally it has a generous block paved driveway to a former garage store, the rear having raised patio seating to the house and a low maintenance garden which is fully daved. VIEWING STRONGLY ADVISED - by appointment ONLY.

£390,000

www.bartons-net.co.uk



- Impressive Four Bedroom Detached Family Home
- SIGNIFICANTLY Side and Rear EXTENDED - Close to HOSPITAL, College, Town and Commuter Transport Links
- Bay Windowed Lounge, Dining Room and separate Rear Sitting Room with Wood Burning Stove
- Stylish Rear Extended Kitchen and Utility, fully fitted STUDY, Downstairs WC
- All Bedrooms with Built-In Storage / Wardrobes, Two With Em-Suites
- Driveway, LOW MAINTENANCE PAVED REAR GARDEN
- Council Tax Band: E, EPC Rating: C, Tenure: FREEHOLD



GROUND FLOOR
991 sq. ft. (92.1 sq. m.) approx.

1ST FLOOR
842 sq. ft. (78.2 sq. m.) approx.

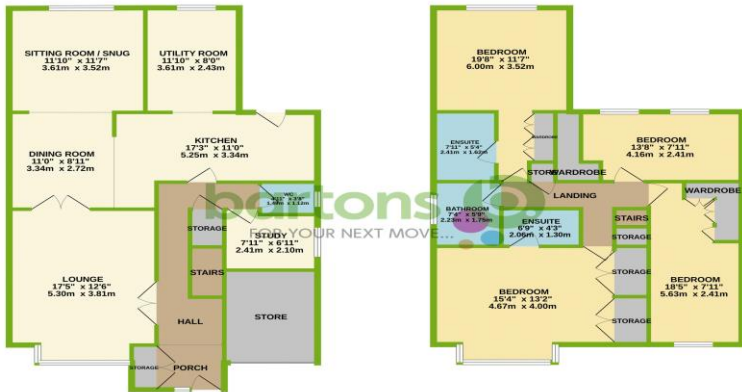

51-53 Moorgate Street, Rotherham, South Yorkshire, S60 2EY
T: 01709 515740 E: info@bartons-net.co.uk