



Dalton Lane, Dalton Parva Rotherham S65 3QJ

£280,000



- **** NEW BUILD ** Semi-Detached Home over Four Levels**
- **High Specification Fixtures & Fittings - CHOOSE YOUR OWN KITCHEN!**
- **Master Bedroom having Walk In Wardrobe Space & En-suite**
- **Enclosed Rear Lawn & Composite Decked Patio Garden**
- **10 year NHBC or equivalent warranty for complete peace of mind**
- **Four Bedrooms, Two Bathrooms & WC**
- **Integral Garage/Workshop & Driveway**
- **FREEHOLD / Council Tax Band TBC**

**** NEW HOME ** Set within the picturesque village location of Dalton Parva - with field views, popular walking trails and Trinity Croft C.of.E Primary School on your doorstep. Making a Fantastic Family Home - this spacious semi-detached property offers versatile living over four floors.**

In brief the accommodation comprises; - Lower Ground Floor - Entrance Hall * WC/Utility Room * Integral Garage - Upper Ground Floor - OPEN PLAN KITCHEN LIVING with French Doors out to the rear Garden - First Floor - Three Bedrooms * Family Bathroom - Second Floor - Master Bedroom * Walk In Wardrobe Space * En-suite Shower Room - Outside - Driveway & Garage Access * Enclosed Rear Composite Decked Patio and Lawn Garden.

To arrange a site visit please contact Barton's New Homes - or email

Estimated Completion - October 2023

Three Plots Available

*Please note, all images are for illustrative purposes only

*Having a choice of fixtures & fittings is subject to early reservation – act quickly!

Location:

Set within the picturesque village location of Dalton Parva - with field views, popular walking trails and Trinity Croft C.of.E Primary School on your doorstep.

A short walk will lead you to a variety of supermarkets, local shops and cafe's within the local village. Whereas the popular Parkgate Retail Park and Rotherham Town Centre are a short drive within a two mile distance. Access to the M1 and M18 Motorway links within a 10 minute drive.



LOWER GROUND FLOOR
481 sq.ft. (44.7 sq.m.) approx.

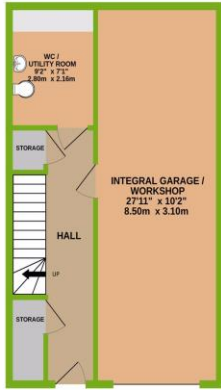

UPPER GROUND FLOOR
440 sq.ft. (40.8 sq.m.) approx.

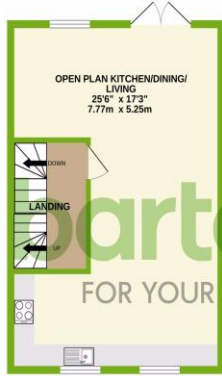

FIRST FLOOR
433 sq.ft. (40.2 sq.m.) approx.

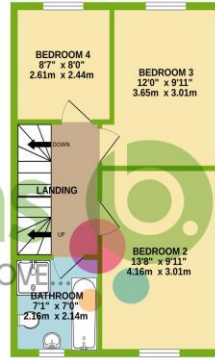

SECOND FLOOR
288 sq.ft. (26.8 sq.m.) approx.



TOTAL FLOOR AREA: 1641 sq.ft. (152.5 sq.m.) approx.

Whilst every attempt has been made to ensure the accuracy of the floorplan contained here, measurements of doors, windows, rooms and any other items are approximate and no responsibility is taken for any error, omission or mis-statement. This plan is for illustrative purposes only and should be used as such by any prospective purchaser. The services, systems and appliances shown have not been tested and no guarantee as to their operability or efficiency can be given.

Made with Metropix ©2023



FREE Property Valuation & Appraisal We offer a FREE of charge property valuation service. Call us now to book your appointment and to find out why we are the agent of choice when selling your home. Our fees are flexible and the service is second to none. Please feel free to visit our website at: www.bartons-net.co.uk

Energy Performance Certificate (EPC) If you are selling a property you will need an Energy Performance Certificate. It contains information on your home's energy use and carbon dioxide emissions. It also contains a recommendation report with suggestions to reduce energy use and carbon dioxide emissions. EPCs carry ratings that compare the current energy efficiency and carbon dioxide emissions with potential figures that the property could achieve. Potential figures are calculated by estimating what they might be if certain energy saving matters were to be put in place. The rating measures the energy and carbon dioxide emission efficiency of a property, using a grade from 'A' down to 'G'. An 'A' rating is the most efficient, whilst 'G' is the least efficient.

Mortgage Services - Make it a great move with a GR8 Mortgage.



Finding the right mortgage needn't be stressful. Bartons have in-house, totally impartial, mortgage advisers who are available to help you find a mortgage that's just right for you. Appointments for general advice are free of charge and available in and out of office hours - call on 01709 515740.

How to make an Offer

If you are interested in this property then it is important that you contact us at your earliest convenience. Failure to do so can result in unnecessary costs and may ultimately lead to you losing out on the property.

For any offer you wish to make we will need to establish certain details before negotiation can take place. This is so that our vendor can make an informed choice when negotiating and accepting your offer. You will be asked to make an early appointment so that we can suitably qualify your position and ability to proceed.

You will be asked to provide formal I.D. and address verification, as required under new Anti-Money Laundering Legislation. You might also have one or two questions for us, such as which solicitor to choose, or which mortgage lender has the best offers available for me. We have a one stop shop to satisfy all of these needs so please ask.

We routinely offer to assist both potential buyers and sellers by referring them to local and regional conveyancing firms to aid with the legal work in respect of a sale and / or purchase. It is your decision whether you choose to deal with them. However, you should be aware that, if you choose to adopt their services we may receive a fee of up to £135 plus VAT for recommending them.



These particulars are issued in good faith but do not constitute representations of fact or form part of any contract. The particulars should be independently verified by prospective buyers or tenants. Neither Barton Real Estates Ltd nor any of its employees or agents has any authority to make or give any representation or warranty whatever in relation to this property.

GENERAL: While we endeavour to make our sales particulars fair, accurate and reliable, they are only a general guide to the property and, accordingly, if there is any point which is of particular importance to you, please contact the office and we will be pleased to check the position for you, especially if you are contemplating travelling some distance to view the property. **SERVICES:** Please note that we have not tested the services or any of the equipment or appliances in this property, accordingly we strongly advise prospective buyers to commission their own survey or service reports before finalising their offer to purchase. **TENURE & PLANNING PERMISSION:** We have not verified the tenure or any planning permission and you and your professional adviser must satisfy yourselves of the tenure and check any planning permissions or building regulations. Any comments about planning and development are for general guide only and your professional adviser must advise you. We cannot give any warranty about development potential. **PHOTOGRAPHY:** In order to obtain the most accurate representation of the property we can use cameras with zoom and telephoto features, this may result in wide-angle shots in some instances. Additionally, the exterior photograph(s) may have been taken from a vantage point other than the front street level. **UNOCCUPIED PROPERTIES:** If the property is unoccupied and the services to it no longer connected we will not have been able to check their condition. Accordingly, we strongly advise prospective buyers to commission their own survey before offering. **VIEWING:** Through the Agents who will be pleased to arrange a mutually convenient time to view the property on 01709 515740.