

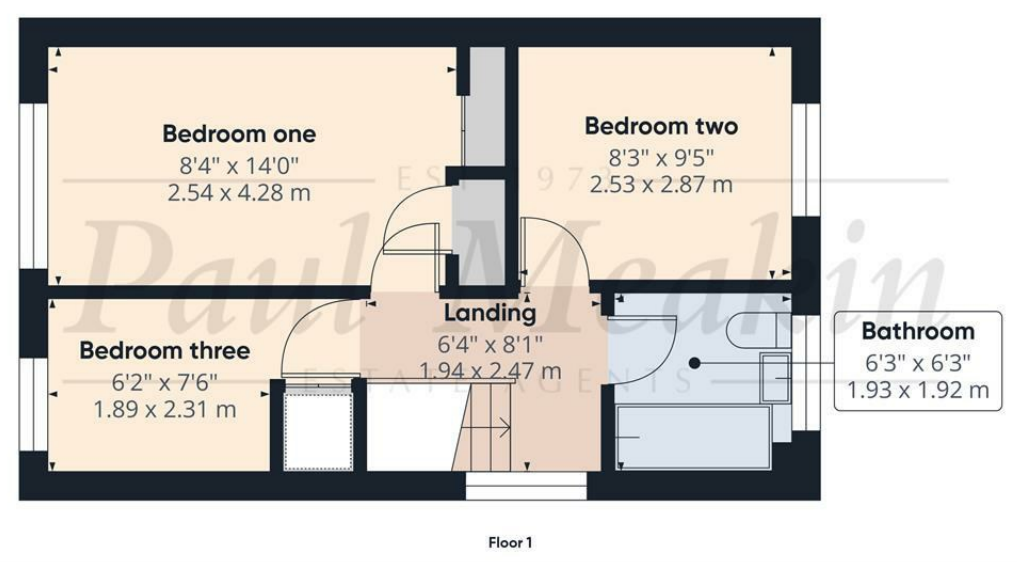

Approximate total area⁽¹⁾
730 ft²
67.8 m²



(1) Excluding balconies and terraces

While every attempt has been made to ensure accuracy, all measurements are approximate, not to scale. This floor plan is for illustrative purposes only.

Calculations are based on RICS IPMS 3C standard.

GIRAFFE360

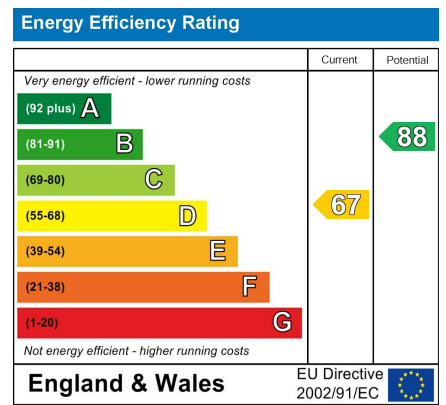

TAX BAND: D

Agents Note: Whilst every care has been taken to prepare these sales particulars, they are for guidance purposes only. All measurements are approximate are for general guidance purposes only and whilst every care has been taken to ensure their accuracy, they should not be relied upon and potential buyers are advised to recheck the measurements



EST 1973
Paul Meakin £450,000 Goldfinch Road, South Croydon, CR2 8SS
ESTATE AGENTS



Nestled in the charming area of Goldfinch Road, this delightful CHAIN FREE three-bedroom house offers a perfect blend of comfort and convenience. Spanning an inviting 730 square feet, the property features a well-proportioned reception room, ideal for both relaxation and entertaining guests.

The three bedrooms provide ample space for family living or can be easily adapted for use as a home office or guest room. The bathroom is thoughtfully designed, catering to the needs of modern living.



Outside, the property benefits from Off-street parking, ensuring ease of access and convenience. The location is well-connected, with local amenities and transport links being just on the street end, making it an excellent choice for families and professionals alike.

This house on Goldfinch Road presents a wonderful opportunity for those seeking a comfortable home in a desirable area. Don't miss the chance to make it your own. EPC D/ Croydon Council/ Tax band D/ FREEHOLD.

Entry

5'0" x 4'5" (1.54 x 1.35)

Living Room

14'6" x 24'9" (4.44 x 7.56)

Kitchen

7'1" x 10'5" (2.16 x 3.19)

Landing

6'4" x 8'1" (1.94 x 2.47)

Bathroom

6'3" x 6'3" (1.93 x 1.92)

Bedroom One

8'3" x 14'0" (2.54 x 4.28)

Bedroom Two

8'3" x 9'4" (2.53 x 2.87)

Bedroom Three

6'2" x 7'6" (1.89 x 2.31)

