

for sale

£560,000



## Fox Covert Drive Road Northampton NN7 2LL

A truly exceptional four bedroom detached bungalow situated on a large plot in an edge of village location. With spacious, flexible living accommodation, re-fitted bathrooms and kitchen, generous plot and cul de sac location this is an amazing opportunity.



# Fox Covert Drive Road Northampton NN7 2LL

## Entrance Porch

Door to the front elevation with an opaque window to the side.

## Entrance Hall

Double glazed door to entrance porch, understairs storage, and stairs leading off to first floor landing. Further doors leading off to shower room, living room, kitchen, and two bedrooms.

## Shower Room

Suite comprising low level flush WC, walk-in shower cubicle and wash hand basin. Heated chrome towel rail, extractor fan and opaque double glazed window to the rear elevation.

## Living Room

16' 7" x 12' 8" ( 5.05m x 3.86m )

Two double glazed windows and double glazed French doors to the rear elevation. Wall mounted radiator.

## Kitchen / Breakfast Room

11' 8" x 13' 1" ( 3.56m x 3.99m )

Fitted with a range of wall and base level units. Stainless steel sink set beneath roll top work surfaces with a swan neck mixer tap over and tiling to splashback areas. Plumbing for dishwasher and space for fridge freezer. Integrated appliances comprising double electric oven, grill and hob with a cooker hood over. Wall mounted radiator and connecting door to study.

## Study

8' 8" max x 16' 1" max ( 2.64m max x 4.90m max )

Double glazed window and door to the rear elevation. Electric heater, and utility cupboard with power and light connected and plumbing for washing machine .Connecting door to garage.

## Bedroom Three

12' 8" x 10' 10" ( 3.86m x 3.30m )

Double glazed window to the front elevation, walk-in wardrobe and wall mounted radiator.

## Bedroom Four

8' 3" x 13' 1" ( 2.51m x 3.99m )

Double glazed window to the rear elevation and wall mounted radiator.

## First Floor Landing

Stairs rising from entrance hall with doors leading off to two bedrooms and the family bathroom.

## Bedroom One

18' 3" max x 13' 1" max ( 5.56m max x 3.99m max )

Double glazed window to the rear elevation and wall mounted radiator.



## Bedroom Two

13' 1" x 10' 10" ( 3.99m x 3.30m )

Double glazed window to the rear elevation and wall mounted radiator.

## Family Bathroom

Suite comprising bath with shower over, low level flush WC and wash hand basin with tiling to the splash back areas and floor. Wall mounted radiator and opaque double glazed window to the rear elevation. Fully tiled.

## Outside

### Front Garden

Mainly laid to gravel, some mature trees and shrubs, and driveway offering off road parking space.

### Garden Office/Gym

16' x 12' ( 4.88m x 3.66m )

Timber construction with power, light and electric heating.

### Rear Garden

Large private rear garden. Mainly laid to lawn with mature planted hedges, shrubs and trees. Patio area which is ideal for entertaining.

## Garage

24' 3" x 9' 5" ( 7.39m x 2.87m )

Up and over door and connecting door to study.







**Ground Floor**

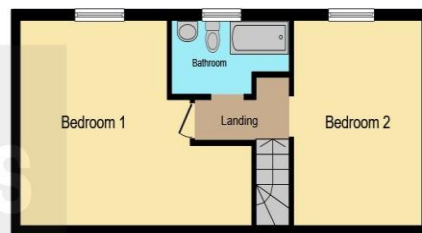

**First Floor**

This floor plan is for illustrative purposes only. It is not drawn to scale. Any measurements, floor areas (including any total floor area), openings and orientation are approximate. No details are guaranteed, they cannot be relied upon for any purpose and they do not form part of any agreement. No liability is taken for any error, omission or misstatement. A party must rely upon its own inspection(s). Powered by [www.focalagent.com](http://www.focalagent.com)

To view this property please contact Connells on

**T 01604 706644**

**E [woottonfields@connells.co.uk](mailto:woottonfields@connells.co.uk)**

11 Tudor Court Wootton Hope Drive Wootton  
NORTHAMPTON NN4 6FF

Property Ref: WFL408351 - 0005

Tenure:Freehold EPC Rating: C

Council Tax Band: D

**check out more properties at [connells.co.uk](http://connells.co.uk)**



1. MONEY LAUNDERING REGULATIONS Intending purchasers will be asked to produce identification documentation at a later stage and we would ask for your co-operation in order that there will be no delay in agreeing the sale. 2. These particulars do not constitute part or all of an offer or contract. 3. The measurements indicated are supplied for guidance only and as such must be considered incorrect. Potential buyers are advised to recheck measurements before committing to any expense. 4. We have not tested any apparatus, equipment, fixtures, fittings or services and it is in the buyers interest to check the working condition of any appliances.

Connells Residential is registered in England and Wales under company number 1489613, Registered Office is Cumbria House, 16-20 Hockliffe Street, Leighton Buzzard, Bedfordshire, LU7 1GN. VAT Registration Number is 500 2481 05.

see all our properties at [www.connells.co.uk](http://www.connells.co.uk) | [www.rightmove.co.uk](http://www.rightmove.co.uk) | [www.zoopla.co.uk](http://www.zoopla.co.uk)