

for sale

£150,000



Piernik Close Swindon SN25 1AS

NO ONWARD CHAIN- PERFECT FOR FIRST TIME AND INVESTMENT BUYERS

Two GOOD-SIZED Bedrooms and a family bathroom. Close to the ORBITAL SHOPPING CENTRE and Thamesdown Drive with access to the A419 which is perfect for commuting.

Piernik Close Swindon SN25 1AS

Accommodation Details

Entrance Hall

Double glazed window to the rear aspect. Storage cupboard. Radiator.

Lounge/kitchen

17' 6" x 11' (5.33m x 3.35m)

Double glazed door with Juliette balcony. Two radiator.

Fully fitted kitchen with wall and base units comprising of cupboard and drawers. Integrated gas hob and electric oven with extractor over. Stainless steel dual sink. Double glazed window the rear aspect.

Bedroom One

10' 10" x 8' 11" (3.30m x 2.72m)

Double glazed window to the front aspect. Storage cupboard. Radiator.

Bedroom Two

10' 10" x 6' 4" (3.30m x 1.93m)

Double glazed window to the front aspect. Storage cupboard. Radiator.

Bathroom

Paneled bath with shower and screen over. W/C and wash hand basin.





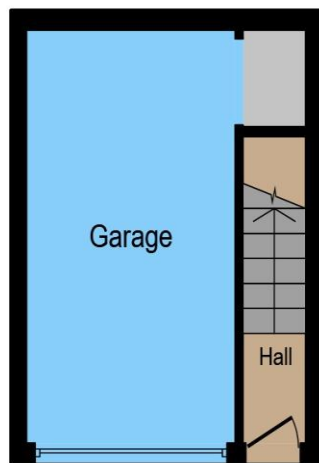

Ground Floor



First Floor

This floorplan is for illustrative purposes only and is not drawn to scale. Measurements, floor-areas, openings and orientations are approximate. They should not be relied upon for any purpose and do not form any part of an agreement. No liability is taken for any error or mis-statement. All parties must rely on their own inspections.

To view this property please contact Connells on

T 01793 708050

E swindonnorth@connells.co.uk

Unit B11 North Swindon District Centre Thamesdown Drive
SWINDON SN25 4AN

Property Ref: SDN311874 - 0006

Tenure: Leasehold

EPC Rating: C

[view this property online connells.co.uk/Property/SDN311874](http://connells.co.uk/Property/SDN311874)

This is a Leasehold property with details as follows; Term of Lease 250 years from 01 Jan 2007. Should you require further information please contact the branch. Please Note additional fees could be incurred for items such as Leasehold packs.

1. MONEY LAUNDERING REGULATIONS Intending purchasers will be asked to produce identification documentation at a later stage and we would ask for your co-operation in order that there will be no delay in agreeing the sale. 2. These particulars do not constitute part or all of an offer or contract. 3. The measurements indicated are supplied for guidance only and as such must be considered incorrect. Potential buyers are advised to recheck measurements before committing to any expense. 4. We have not tested any apparatus, equipment, fixtures, fittings or services and it is in the buyers interest to check the working condition of any appliances.

Connells Residential is registered in England and Wales under company number 1489613, Registered Office is Cumbria House, 16-20 Hockliffe Street, Leighton Buzzard, Bedfordshire, LU7 1GN. VAT Registration Number is 500 2481 05.

see all our properties at www.connells.co.uk | www.rightmove.co.uk | www.zoopla.co.uk