



Stroud Gate, South Harrow, HA2 8JL

£2,100 PCM





Stroud Gate

South Harrow, HA2 8JL

- THREE BEDROOM HOUSE
- TWO RECEPTION ROOMS
- GAS CENTRAL HEATING
- FURNISHED/UNFURNISHED
- OFF ROAD PARKING FOR TWO CARS
- MID TERRACED
- SEPARATE FITTED KITCHEN
- DOUBLE GLAZED
- WELL KEPT GARDEN
- AVAILABLE 7th NOVEMBER

Well presented three bedroom mid terraced property, with a 12'8 x 11'5 front reception room, 11'6 x 10'10 rear reception, 10'10 x 6' separate fitted kitchen with gas cooker, washing machine and dishwasher, three bedrooms measuring 12'9 x 10'9 with freestanding wardrobes, 11'1 x 11' with fitted wardrobes and 7'4 x 6'1. Family bathroom with corner bath and electric shower over. Approximately 50' rear garden with patio leading to lawn and spacious double timber shed with electricity. Off road parking for 2 cars. Double glazed and gas central heating. Furnished/unfurnished. Conveniently located for Northolt Park's Chiltern Railways overline station (110 yards) 16 mins to Marylebone. 1/2 mile from South Harrow's Piccadilly Line tube and bus stations and 3/4 mile to Northolt's Central Line tube station.

Council Tax Band: D - £2,042 per annum





Council Tax Band - D

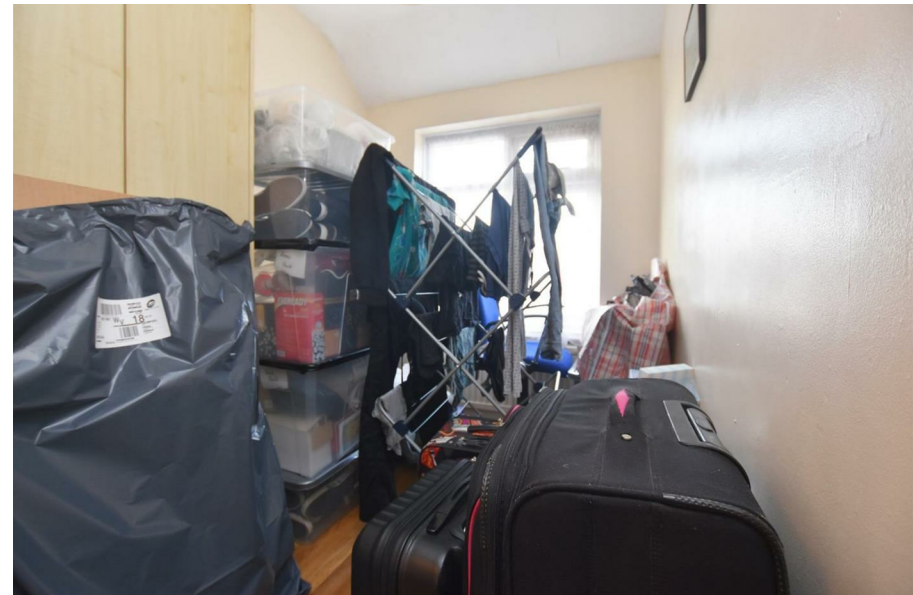



Floor Plans

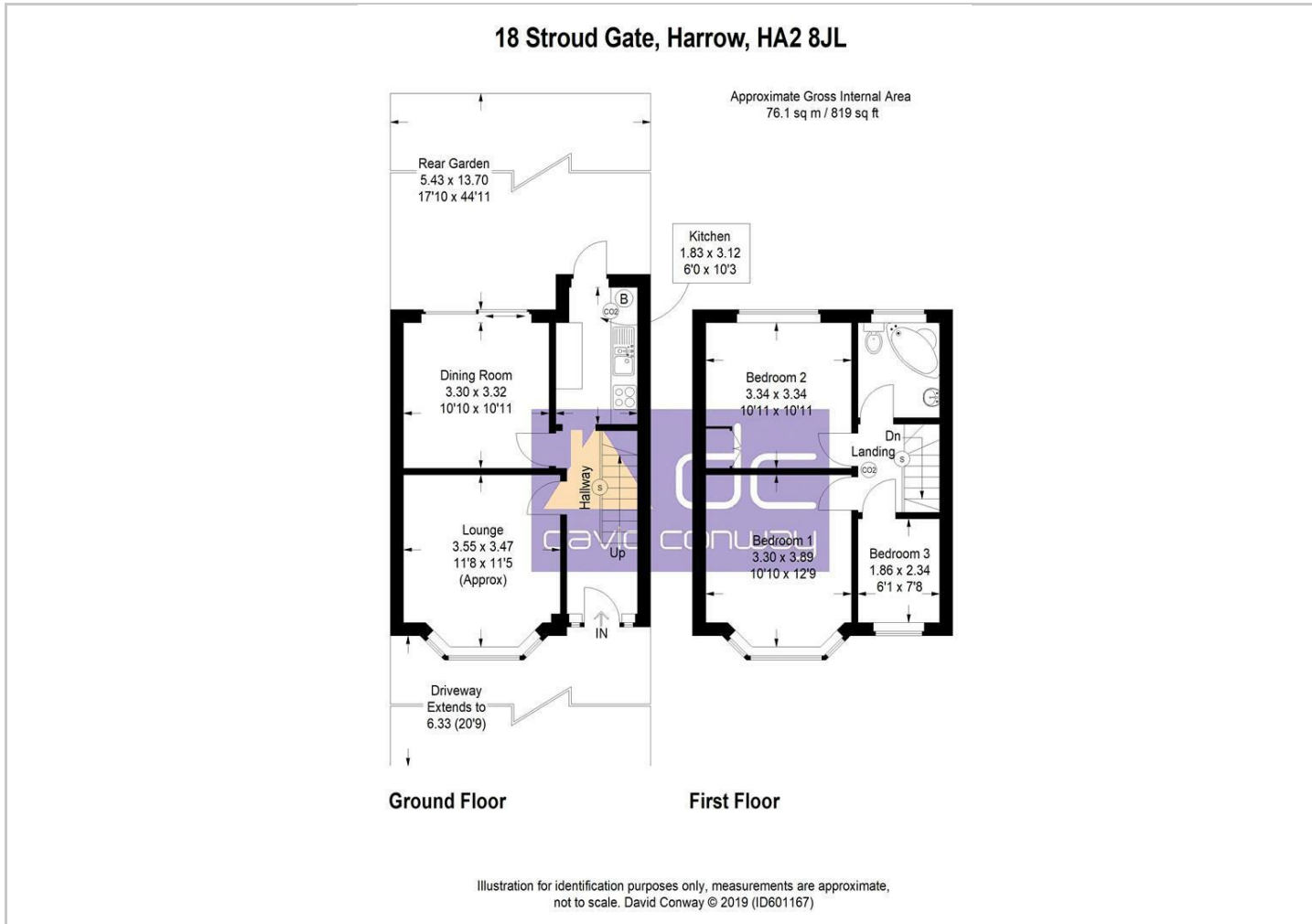

Viewing

Please contact our David Conway & Son Ltd Office on 02084225222 if you wish to arrange a viewing appointment for this property or require further information.

The particulars are set out as a general outline only for the guidance of intended purchasers or lessees, and do not constitute, any part of a contract. Nothing in these particulars shall be deemed to be a statement that the property is in good structural condition or otherwise nor that any of the services, appliances, equipment or facilities are in good working order. Purchasers should satisfy themselves of this prior to purchasing.

269 Northolt Road, Harrow, Middlesex, HA2 8HS
Tel: 02084225222 Email: pm@davidconway.co.uk <https://www.davidconway.co.uk/>

Location Map

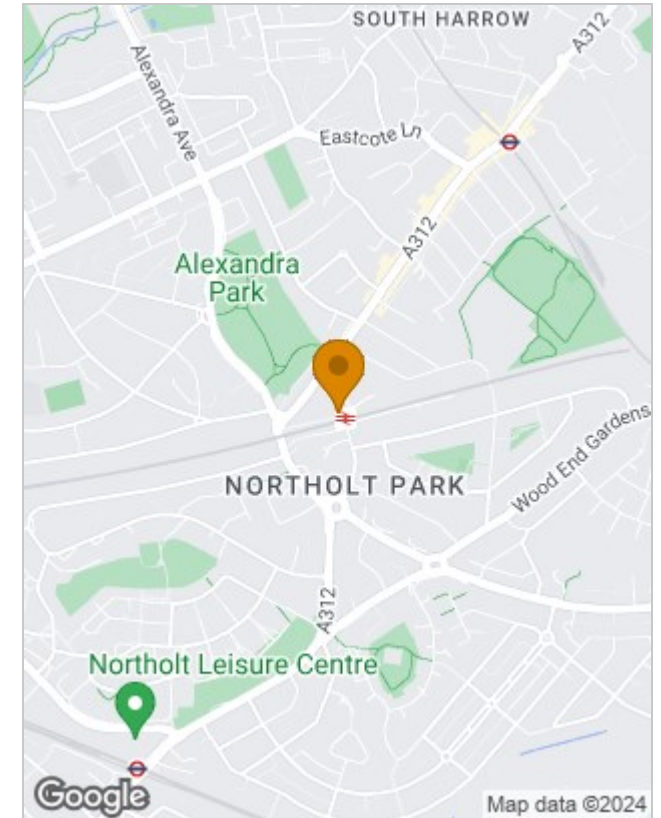

Energy Performance Graph

