



Southdown Crescent, Harrow, HA2 0QT

Asking Price £525,000



Southdown Crescent, Harrow, HA2 0QT

This beautifully presented three-bedroom terraced house on Southdown Crescent, Harrow. The property features a welcoming hallway, a through lounge with a front-aspect bay window and rear French patio doors, a fitted kitchen with modern appliances, and a fully tiled family bathroom. Upstairs, there are two spacious double bedrooms with fitted wardrobes and bay windows with custom made blinds to windows, plus a cosy single bedroom. Externally, it boasts a well-maintained front garden and a rear garden with a patio, lawn, raised deck area, and a charming summer house with storage. Conveniently located near local schools and transportation links, including South Harrow Underground Station, this home is perfect for families seeking comfort and accessibility.

- Terraced House
- Three Bedrooms
- Through Lounge
- Fitted Kitchen
- Modern Bathroom
- Front Garden & Rear Garden
- Summer House With Storage Room
- Catchment Area For St. Anselms Primary School
- Gas Central Heating & Double Glazing
- Well Presented

Council Tax Band: D

Freehold





INTERNALLY

This is a beautifully presented three-bedroom terraced house. Upon entering, you are greeted by a welcoming hallway that features stairs to the first floor and doors leading off to various rooms. The through lounge boasts a large front-aspect bay window with custom made blinds, flooding the space with natural light, while the rear dining area features French patio doors that open onto the garden. The fitted kitchen is well-equipped with matching wall and base units, ample counter top space, a gas hob with an extractor fan, a 1 1/2 bowl stainless steel sink with a drainer, a wall-mounted boiler, and a large window offering a pleasant view of the garden. Additionally, there is a rear door providing direct access to the garden.

Stairs to the first floor landing with doors leads to two spacious double bedrooms, both featuring fitted wardrobes and large bay windows with custom made blinds, a cozy single bedroom, and a fully tiled family bathroom. The bathroom includes a panel-enclosed P-shaped bath with a shower unit and screen, a vanity unit with a hand basin, and a WC.

EXTERNALLY

Well-maintained front garden with a pathway, and a rear garden that includes a patio area, laid to lawn area, a pathway leading to a raised decking area featuring a charming summer house. The summer house is an excellent space for work or relaxation and includes a door to a convenient storage area.

LOCATION

Southdown Crescent is located off Roxeth Green Avenue situated between Eastcote Lane and Shaftesbury Avenue. There are a number of local schools including Whitmore High School 0.3 miles away, Grange Primary School and Roxeth Mead School both 0.6 miles away, The John Lyon School and Roxeth Primary School both 0.7 miles away and The Welldon Park Academy 0.9 miles away. South Harrow Underground Station and Bus station is 0.7 miles away situated on Northolt Road which has ample restaurants, shops and local amenities. West Harrow Underground Station is 0.9miles away and Rayners Lane Underground Station 1.1 miles away.



Floor Plan

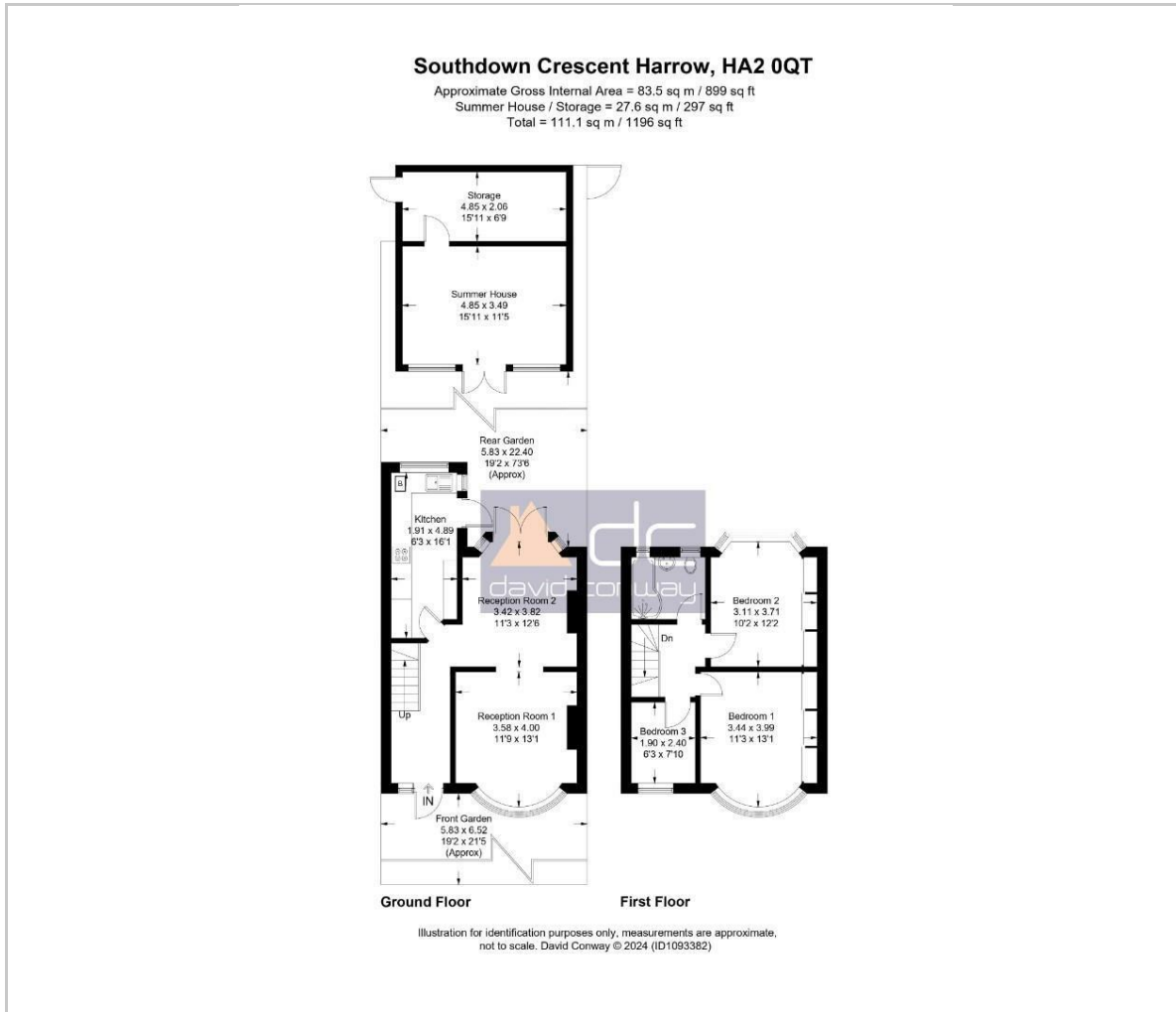

Viewing

Please contact our David Conway & Co Ltd Office on 02084225222 if you wish to arrange a viewing appointment for this property or require further information.

These particulars, whilst believed to be accurate are set out as a general outline only for guidance and do not constitute any part of an offer or contract. Intending purchasers should not rely on them as statements of representation of fact, but must satisfy themselves by inspection or otherwise as to their accuracy. No person in this firms employment has the authority to make or give any representation or warranty in respect of the property.

269 Northolt Road, Harrow, Middlesex, HA2 8HS
 Tel: 02084225222 Email: sales@davidconway.co.uk <https://www.davidconway.co.uk/>

Area Map



Energy Efficiency Graph

