



**BROOK**  
INDEPENDENT  
ESTATE AGENTS

57 Nelson Avenue, Portsmouth, PO2 8NJ



# A two double bedroom mid terrace home with super stylish interior, social kitchen diner & west facing rear garden £270,000

## ACCOMMODATION & FEATURES

- **Lovely Living Room With Bay Window To Front**
- **Impressive Kitchen/Diner With Integral Appliances**
- **Beautifully Decorated With A Clever Mix Of Traditional and Contemporary Features**
- **Downstairs Cloakroom**
- **Two Well Proportioned Double Bedrooms**
- **Modern Bathroom With Shower Over Bath**
- **Gas Central Heating**
- **Double Glazing**
- **South West Facing Rear Garden**







Welcome to this beautifully presented two-bedroom terraced home located on Nelson Avenue, Portsmouth. Combining traditional charm with modern contemporary features, this property offers the perfect blend of style and comfort. Upon entering, you're greeted by a welcoming entrance hallway, leading into a spacious living room complete with a large bay window, flooding the space with natural light and creating a bright and airy atmosphere. The room retains its classic charm while being elegantly decorated, making it ideal for both relaxation and entertaining.

The heart of the home is the modern kitchen/diner, designed to a high standard with sleek, integrated appliances. This open-plan space is perfect for family meals or hosting guests, offering a contemporary feel while maintaining warmth and character.

The ground floor also benefits from a convenient downstairs cloakroom, enhancing the practicality of the home.

Upstairs, you'll find two well-proportioned bedrooms, each offering ample space and stylish décor. The modern family bathroom completes the first floor, featuring a bath with a shower over, providing both convenience and comfort.

Further highlights of the property include gas central heating, ensuring warmth throughout the year.

This delightful home is a fantastic opportunity for anyone seeking a property that blends traditional appeal with modern living. Early viewing is highly recommended to fully appreciate all it has to offer.



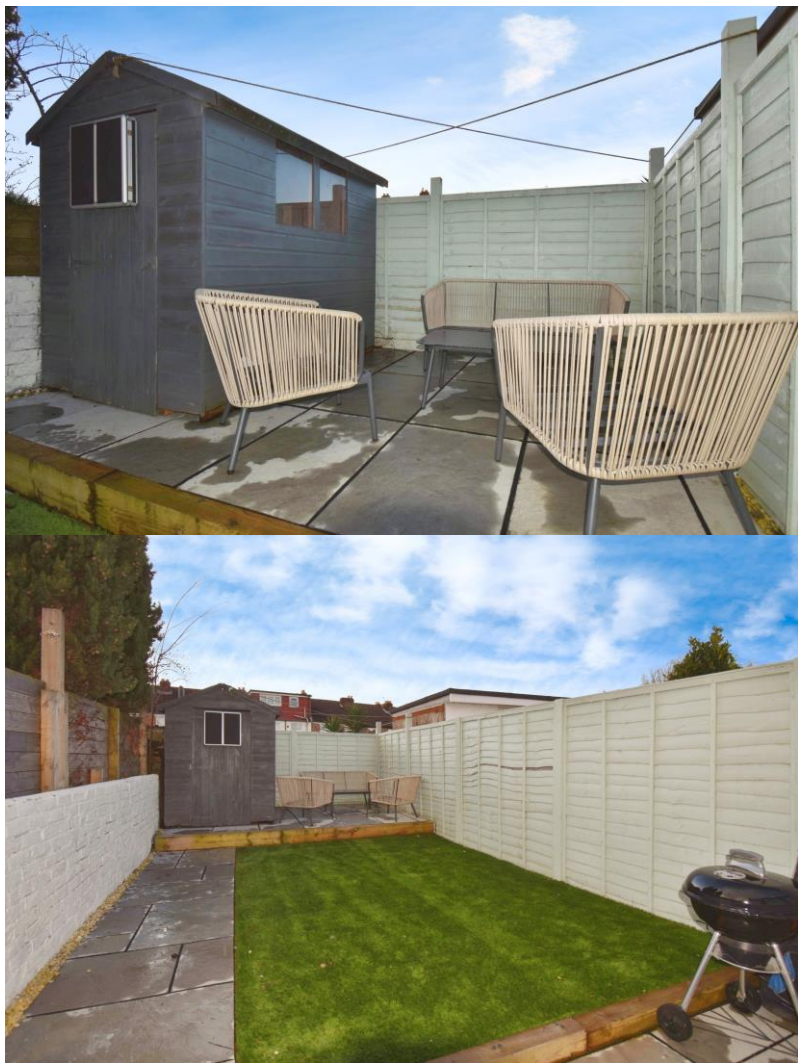

GROUND FLOOR  
277 sq.ft. (25.7 sq.m.) approx.

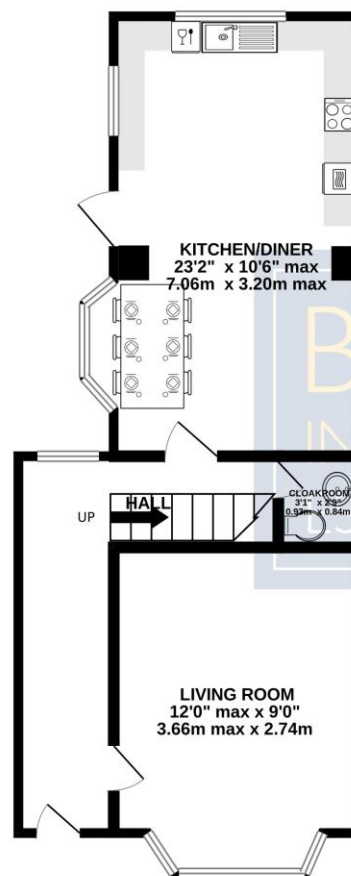

1ST FLOOR  
231 sq.ft. (21.5 sq.m.) approx.

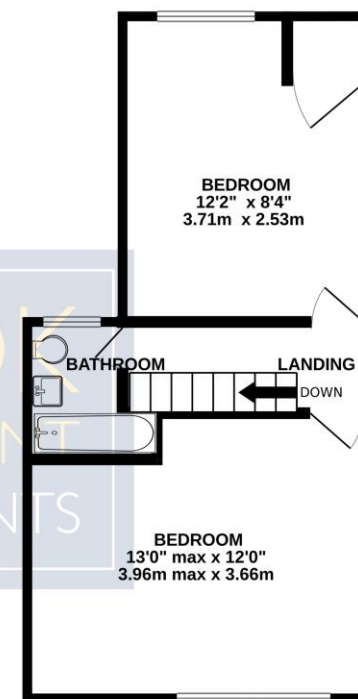

TOTAL FLOOR AREA : 508 sq.ft. (47.2 sq.m.) approx.

Whilst every attempt has been made to ensure the accuracy of the floorplan contained here, measurements of doors, windows, rooms and any other items are approximate and no responsibility is taken for any error, omission or mis-statement. This plan is for illustrative purposes only and should be used as such by any prospective purchaser. The services, systems and appliances shown have not been tested and no guarantee as to their operability or efficiency can be given.  
Made with Metropix ©2025

**BROOK**  
INDEPENDENT  
ESTATE AGENTS

These particulars do not constitute any part of an offer or contract. None of the statements contained in these particulars are to be relied upon as statements or representations of fact and any intending purchaser must satisfy himself by inspection or otherwise to the correctness of each of the statements contained in these particulars. The vendor does not make or give, and neither Brook, nor any person in their employment has any authority to make or give, any representation or warranty whatever in relation to this property.

33 Middle Road, Park Gate, Southampton SO31 7GH  
Tel: 01489 885500 admin@brookindependent.co.uk  
**www.brookindependent.co.uk**

rightmove ZOOPLA PrimeLocation.com