



Westbourne Court, 158 Wilson Road, Reading, RG30 2RW

£175,000

Walmisley

Westbourne Court, 158 Wilson Road, Reading, RG30 2RW

A well-presented two-bedroom first-floor apartment, located within walking distance of Reading town centre and West Reading train station. The accommodation includes an entrance hall, lounge/dining area, open-plan kitchen with integrated oven, one double bedroom, one single bedroom, and a bathroom. Additional features include a security entry system, allocated parking, and access to communal grounds. Offered with no onward chain. EPC rating C. Council tax band C.

** Photographs taken prior to current tenancy **

* Length of lease: 125 years from 1992; 92 years remaining.

* Service charge £1783.78.

* Ground rent £0

<https://moverly.com/sale/5rtE3uUovNmdjokNuldNd/view>

Tenure - Leasehold





- Modern apartment
- Parking
- Close To Town Centre
- Secure Entry System
- Council Tax Band C
- EPC C

 2
  1
  1
  C

RESIDENTIAL SALES • LETTINGS • PROPERTY MANAGEMENT • NEW HOMES





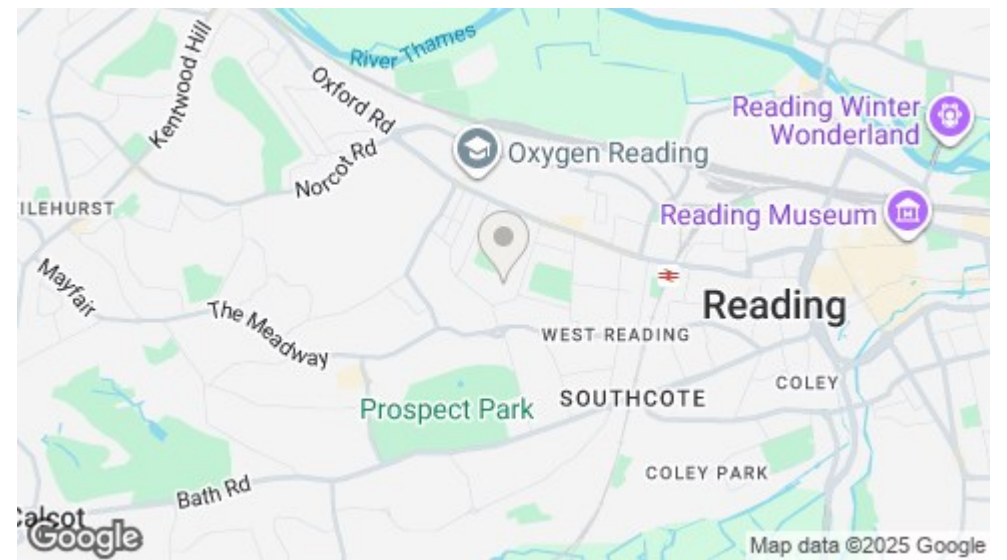

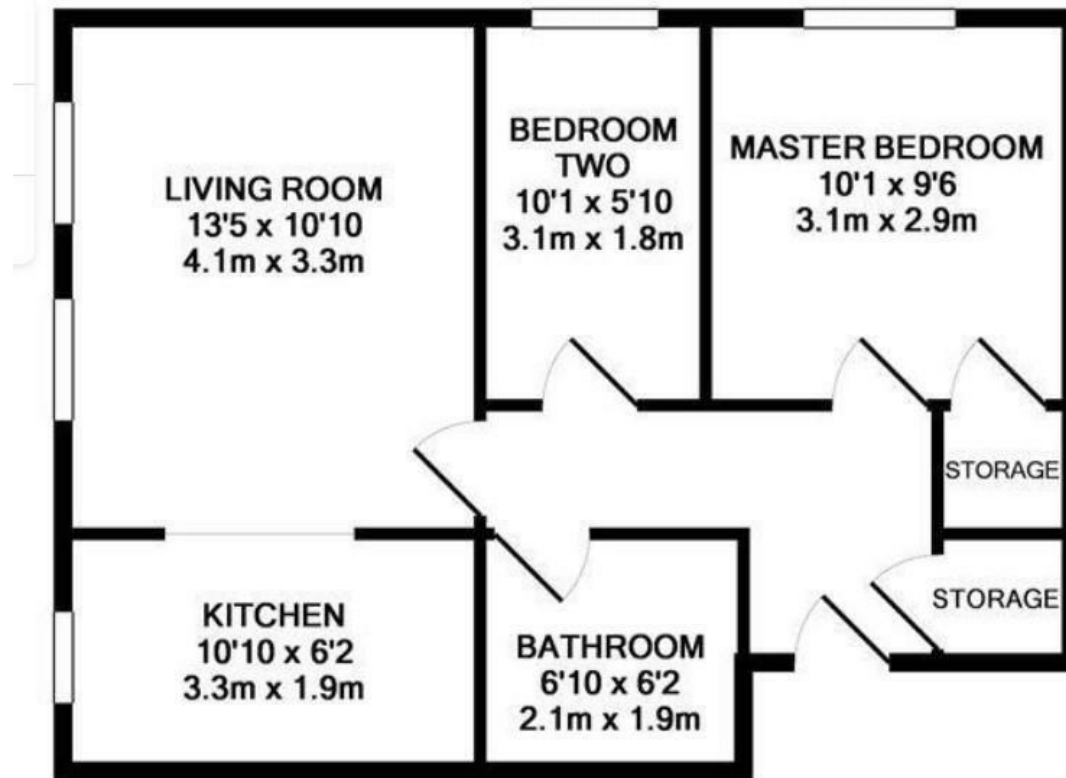

Important: Walmsley Estate Agents would inform prospective purchasers that these sales particulars have been prepared as a general guide only. A detailed survey has not been carried out, nor the services, appliances and fittings tested. Room sizes should not be relied upon for furnishing purposes and are approximate. If floor plans are included, they are for guidance only and illustration purposes only and may not be to scale. If there are any important matters likely to affect your decision to buy, please contact us before viewing the property.



9-11 Bridge Street, Caversham, Reading, RG4 8AA
Email: cavershamsales@walmsley.co.uk www.walmsley.co.uk

0118 947 0511

