



Dellwood Park, Caversham, Reading, RG4 7NX

£485,000

Walmsley



# Dellwood Park, Caversham, Reading, RG4 7NX

Walmsley Estate Agency are delighted to offer the market this superb first floor apartment, built by Messrs T A Fisher, situated in an exclusive gated complex, within private landscaped grounds. The accommodation comprises secure communal entrance, large private entrance hallway, a grand bay-fronted sitting/dining room, a separate kitchen, three bedrooms, large en-suite to master bedroom and family bathroom suite.

Situated within close proximity of Caversham centre; with its comprehensive shopping facilities, restaurants and bus services that lead to Reading mainline station (Paddington 25 minutes). Other facilities within the immediate area are schools at both Primary and secondary level, golf courses and country walks through Hemdean Valley. Viewing highly recommended.

EPC - C  
Ground Rent - £400 per year  
Service charge - £3,747.00  
Tax Band - E

<https://moverly.com/sale/j68iQmT5Mj29npfH1zTY9a/view>

## Tenure - Leasehold







- Caversham Heights
- Modern gated complex
- Three bedrooms
- Built by messrs. T A Fisher
- Two parking spaces
- Well-presented accommodation

 3
  2
  1
  C

RESIDENTIAL SALES • LETTINGS • PROPERTY MANAGEMENT • NEW HOMES

**Walmesley**









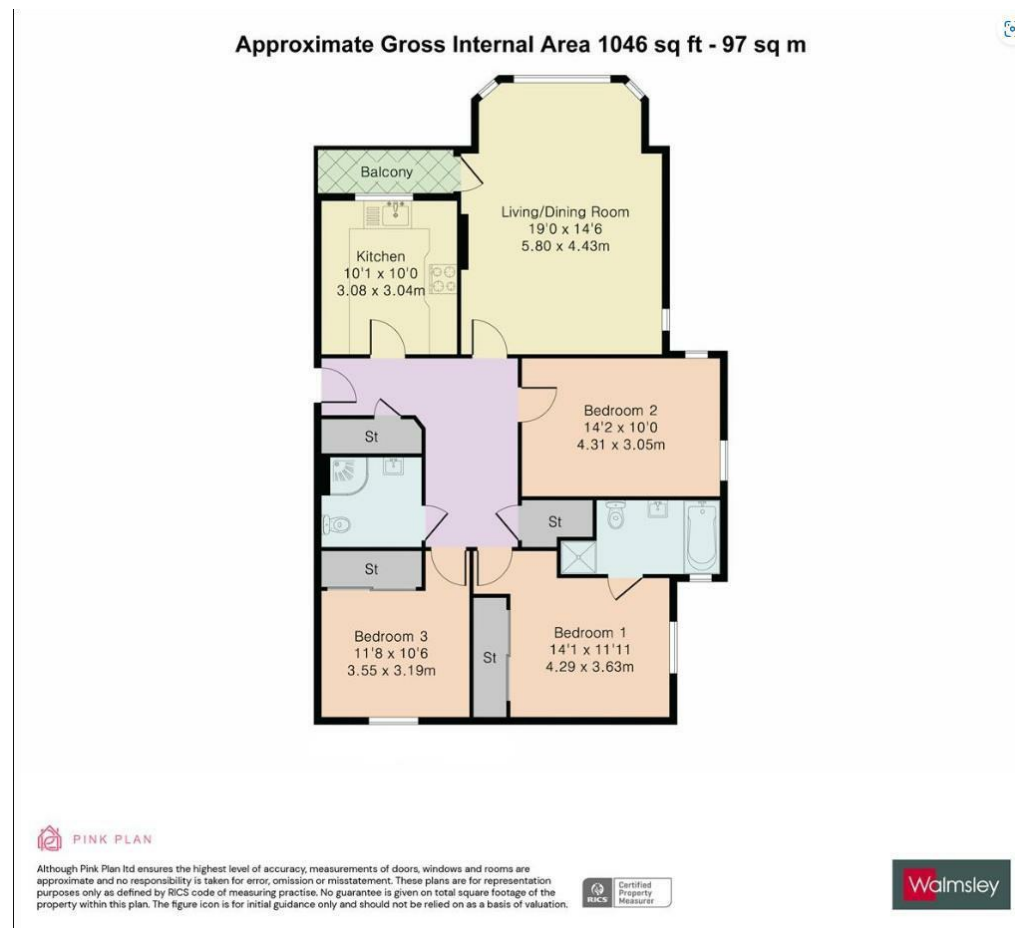

Important: Walmsley Estate Agents would inform prospective purchasers that these sales particulars have been prepared as a general guide only. A detailed survey has not been carried out, nor the services, appliances and fittings tested. Room sizes should not be relied upon for furnishing purposes and are approximate. If floor plans are included, they are for guidance only and illustration purposes only and may not be to scale. If there are any important matters likely to affect your decision to buy, please contact us before viewing the property.



9-11 Bridge Street, Caversham, Reading, RG4 8AA  
Email: [cavershamsales@walmsley.co.uk](mailto:cavershamsales@walmsley.co.uk) [www.walmsley.co.uk](http://www.walmsley.co.uk)

0118 947 0511

