

Flat 5, Crayshaw Court Abbotsmead Place,
Caversham, Reading, RG4 8EQ

£225,000 Leasehold



A well appointed ground floor apartment situated in an excellent location in central Caversham with many amenities close by, including, doctors surgery, bus stops, a wide variety of shops, post office, library along with parkland and the River Thames. The apartments are for residents over the age of 60 years and include a lift to all floors, a disabled platform lift, sky connection points, secure entry system with CCTV, laundry room, mobility scooter store and charging point and store, 24 hour emergency call system, fire detection equipment and landscaped gardens. This well proportioned apartment is presented in good condition, enjoying a large lounge/dining room, fitted kitchen, double bedroom with wardrobe and spacious shower room. There is also a spacious residents lounge and a guest suite is available for visitors. No onward chain. EPC Rating C. Council Tax Band D.

Lease Length - 125 from new, approximately 114 years remaining

Ground Rent - Currently £425

Service Charge - Currently £3,095.44



walmsley.co.uk



Floor Plan

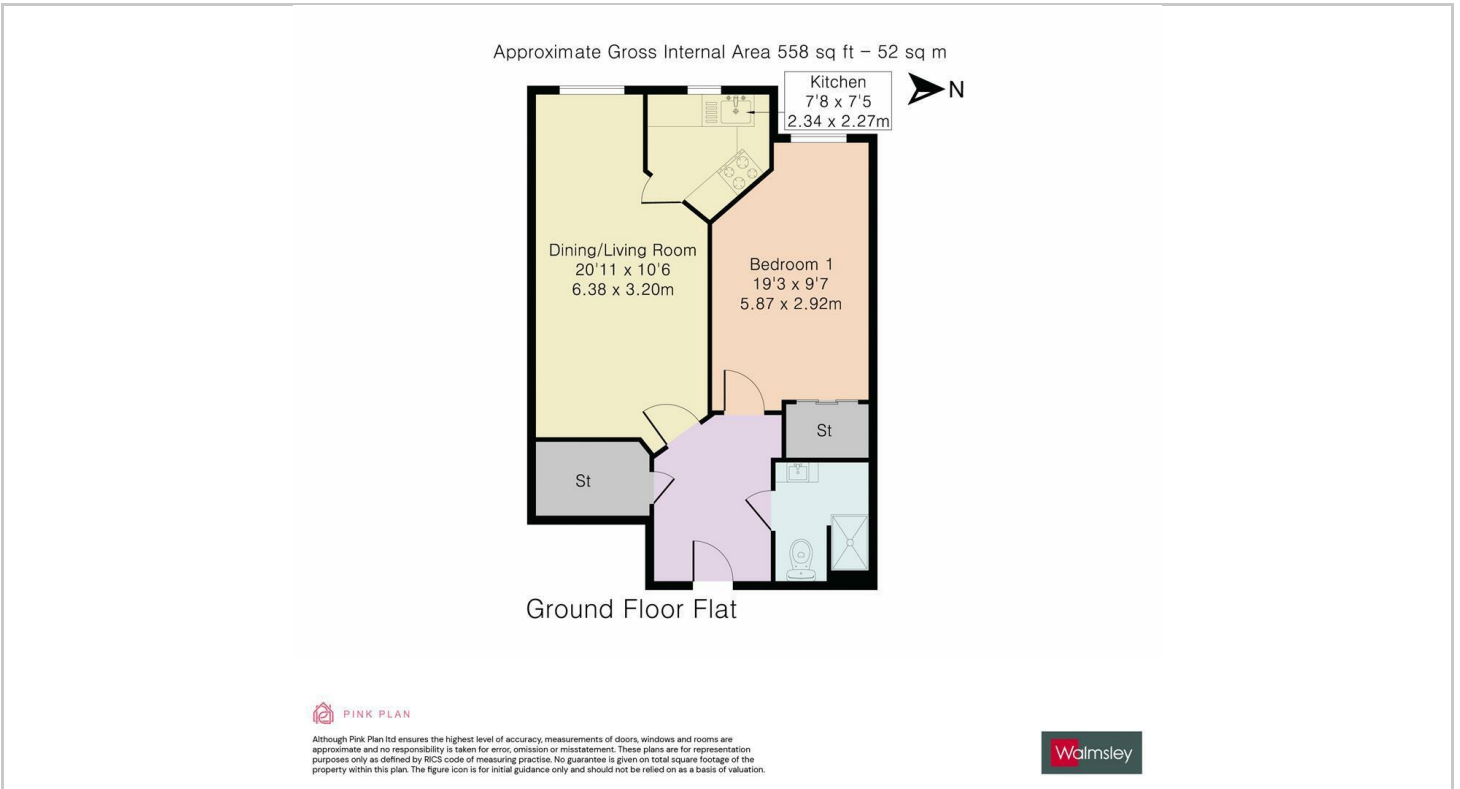

These particulars, whilst believed to be accurate are set out as a general outline only for guidance and do not constitute any part of an offer or contract. Intending purchasers should not rely on them as statements of representation of fact, but must satisfy themselves by inspection or otherwise as to their accuracy. No person in this firm's employment has the authority to make or give any representation or warranty in respect of the property.