



Naoroji Street, WC1X

£3,600 Per calendar month

A modern apartment in a concierge served block next to the famous Exmouth Market. This apartment is in excellent condition and has direct access to a large private terrace

Within close proximity to Kings Cross, Angel and Farringdon station, this property offers fantastic transport links as well as access to the amenities of Angel and Exmouth Market

Features

- Private Terrace
- Two Double Bedrooms
- Two Bathrooms
- Concierge
- Lift Access
- Excellent Connections

Naoroji Street,
London, WC1X

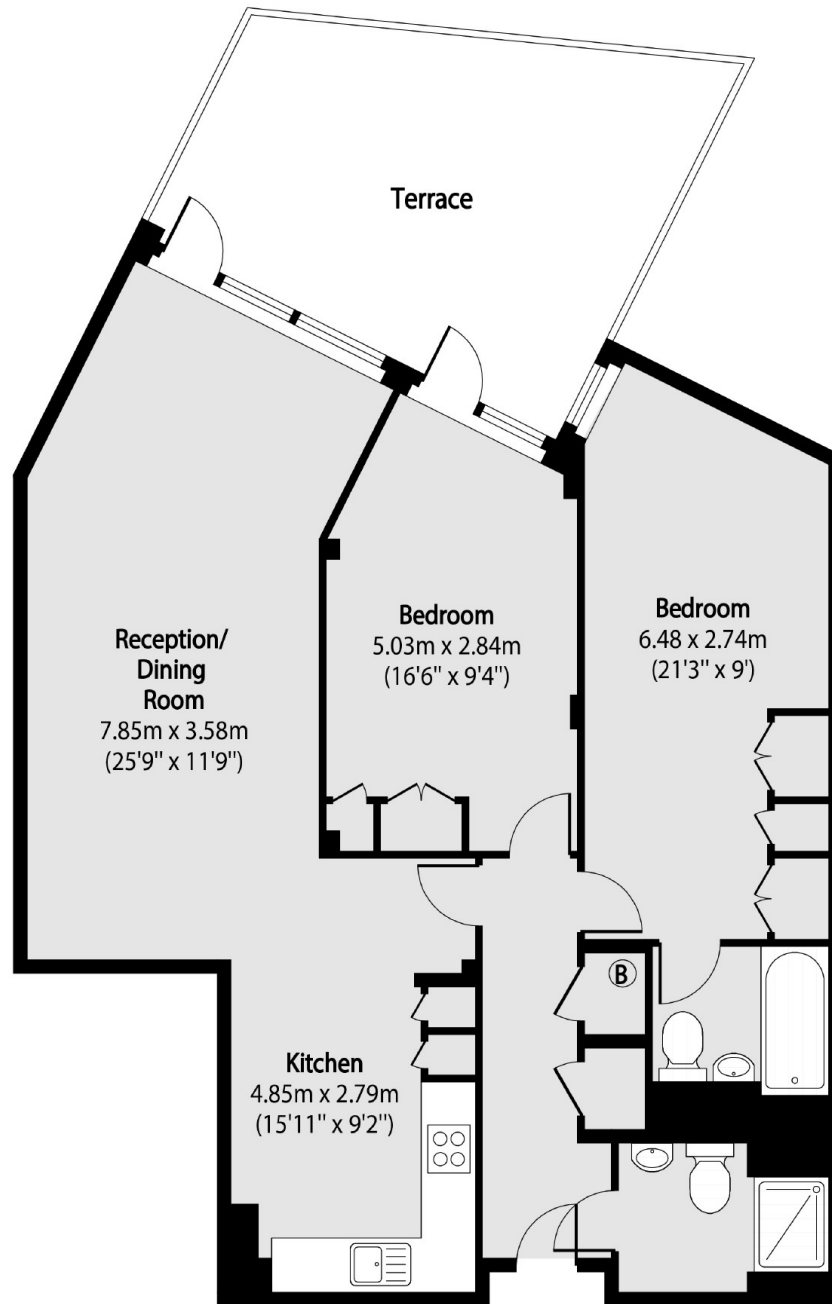

Total area (approx): 81.94 sq m (882 sq. ft)

Terrace total area (approx): 19.32 sq m (208 sq. ft)

Dexters

Clerkenwell
1b Britton St
London
EC1M 5NW
Lettings
020 7483 6370

Energy Rating: . We aim to make our particulars both accurate and reliable. However they are not guaranteed; nor do they form part of an offer or contract. If you require clarification on any points then please contact us, especially if you're traveling some distance to view. Please note that appliances and heating systems have not been tested and therefore no warranties can be given as to their good working order.

 **RICS** | Regulated
Estate Agent
and Letting Agent

[dexters.co.uk](https://www.dexters.co.uk)