



Central Street, EC1V

£3,650 Per week

A modern two double bedroom, two bathroom apartment with balcony, communal roof terrace and daytime concierge. In the heart of Clerkenwell next to plenty of bars and restaurants. Perfect for professionals.

Worcester Point is located on Central Street, about a half mile to Barbican and Farringdon stations, and about three quarters of a mile to Angel and Old Street stations.

Features

- Two Bed
- Two Bath
- Balcony
- Daytime Concierge
- Furnished
- Parking

Central Street, London, EC1V

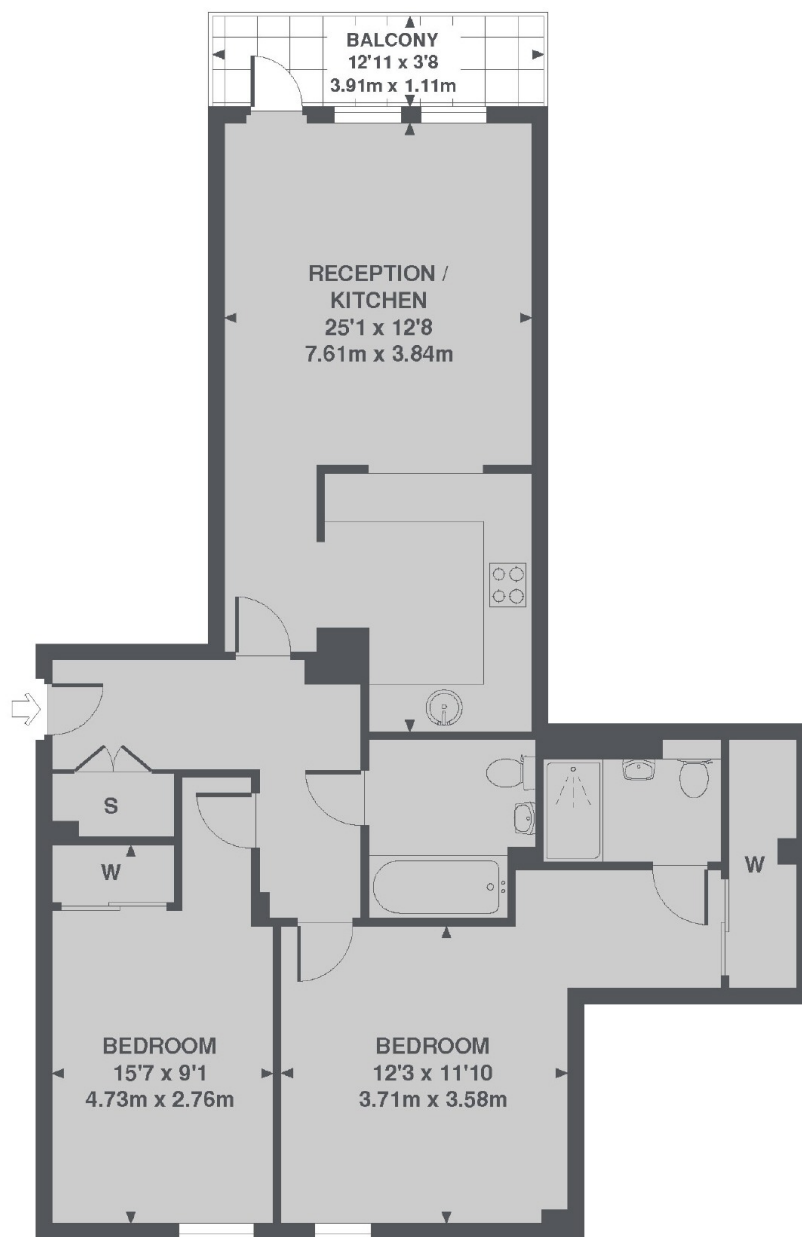

SECOND FLOOR

TOTAL APPROX. FLOOR AREA 856 SQ. FT. (79.5 SQ. M.)