

Baldwins Gardens, EC1N

£4,800 Per calendar month

A stunning apartment in an exclusive complex with three bathrooms, private terrace and a spacious reception room with windows on either side of the room bringing in plenty of natural light throughout the day.

The apartment is excellently located for the amenities of Bloomsbury, City and the West End with Chancery Lane, Farringdon and King Cross stations within walking distance

Features

- Private Terrace
- Two Double Bedrooms
- Two Ensuite and One WC
- Lift Access
- Underfloor Heating
- Central Location

Baldwins Gardens, London, EC1N

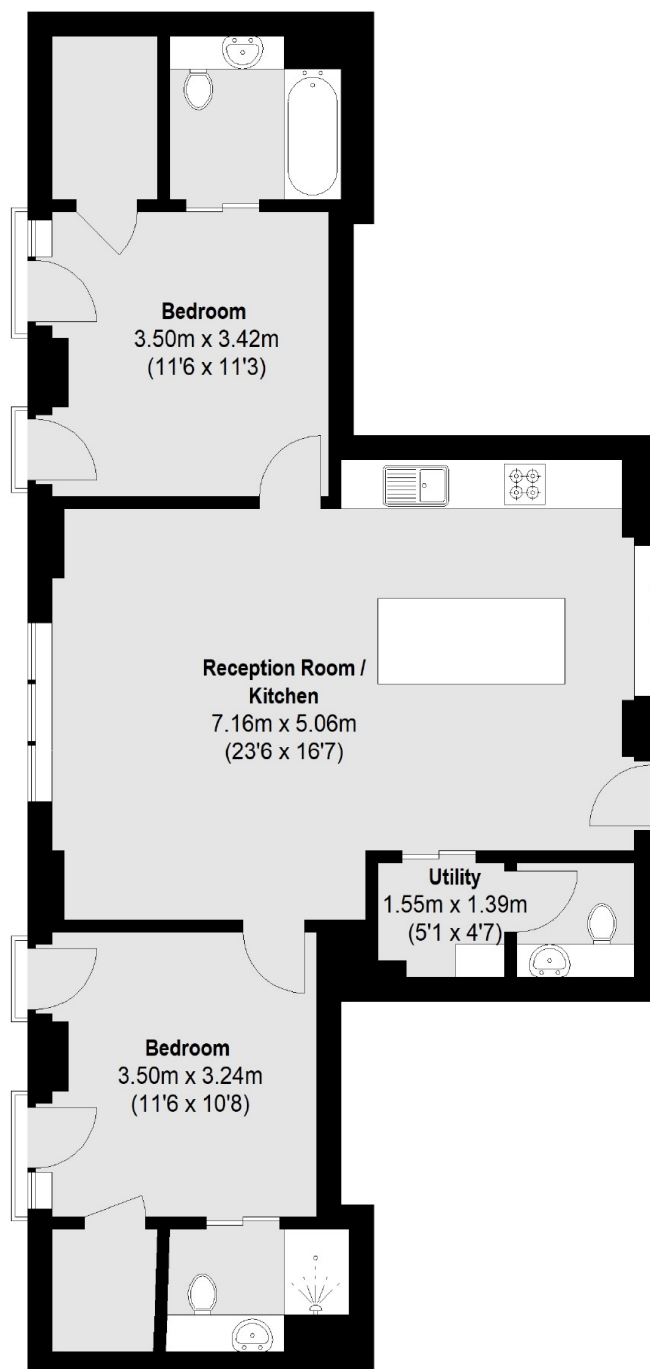

Total area (approx.): 79.78 sq. m (859 Sq. ft)