



**POOLE
TOWNSEND**

Rusland Crescent, Ulverston, LA12 9LX

£270,000

2 1 1



- Freehold
- Council tax band C
- Semi-detached bungalow
- Off road parking and garage
- 2 bedrooms and spacious loft room
- Sought after location
- Modern kitchen and shower room
- Open plan living area room
- Gardens and greenhouse
- No upper chain



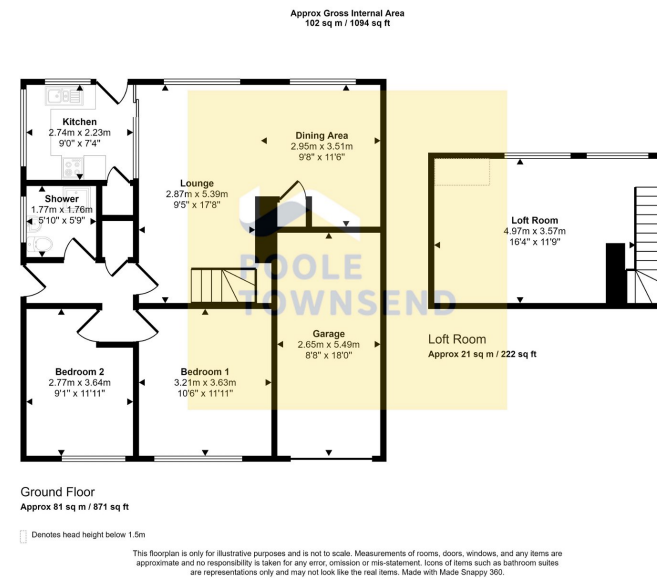

This semi-detached bungalow is located in a sought after part of the town, benefiting from a passing bus service that is just a few stops away from the town centre. The accommodation has been extended and includes a large loft room in addition to the ground floor accommodation where there is a spacious lounge/dining room, modern fitted kitchen, two bedrooms and a shower room. There is modern UPVC framed double glazing throughout and also a gas-fired central heating system with a condensing boiler. There are areas of garden to the front and rear, a private driveway and an integral garage. No upper chain.

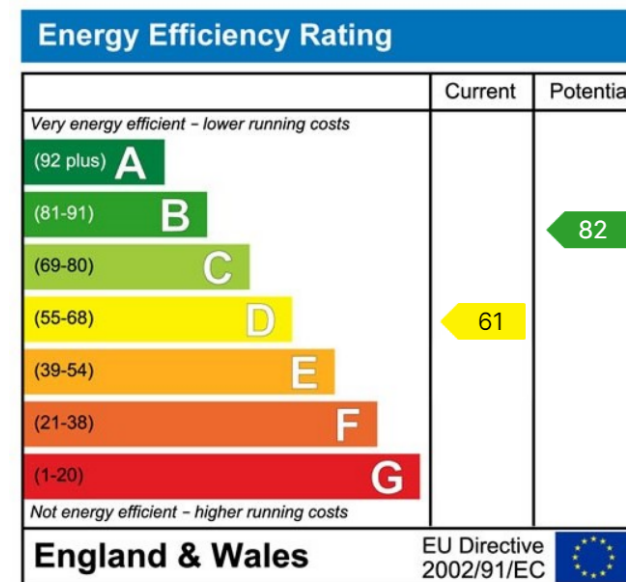

Visit us at
www.pooletownsend.co.uk
enquiries@pooletownsend.co.uk

We are open
 Monday – Friday 9.00 – 5.00
 Saturday 9.00 – 1.00

Barrow 01229 811811
 Ulverston 01229 588111
 Grange 015395 33316
 Kendal 01539 734455
 Milnthorpe 015395 62044