



**POOLE
TOWNSEND**

Rusland Crescent, Ulverston

Offers Over £300,000

3 1 2



- Excellent semi detached true bungalow
- 2 reception rooms
- Stylish modern kitchen
- 3 bedrooms
- Attractive gardens
- Sought after Croftlands location
- Light and airy throughout
- Plenty of driveway parking & garage
- No upper chain
- Freehold & Council tax band C



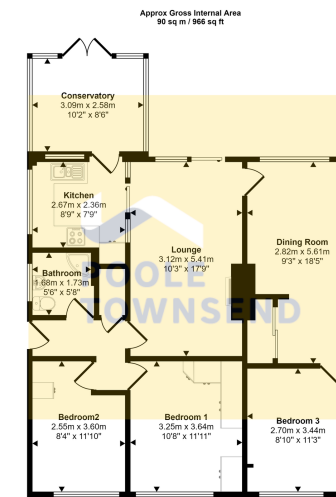

Floorplan

This floorplan is only for illustrative purposes and is not to scale. Measurements of rooms, doors, windows, and any items are approximate and no responsibility is taken for any error, omission or mis-statement. Icons of items such as bathroom suites are representations only and may not look like the real items. Made with Made Snappy 360.

This well presented semi-detached bungalow is located in a sought after part of the town, benefiting from a passing bus service that is just a few stops away from the town centre. Croftlands has a variety of amenities including a launderette/dry cleaners, hairdressing salon and a convenience store with an off-licence and Post Office. There is also an infants and junior school, a community centre and leisure complex with swimming pool. The accommodation has been extended into the original garage to make a 3rd bedroom. The bungalow has a large lounge area and separate dining room with ample storage. There are 3 double bedrooms, recently fitted modern kitchen and shower room. The property benefits from 2 driveways to park plenty of vehicles and also a detached garage. There is modern UPVC framed double glazing throughout and also a gas-fired central heating system. No upper chain.

Visit us at

www.pooletownsend.co.uk

enquiries@pooletownsend.co.uk

We are open

Monday – Friday 9.00 – 5.00

Saturday 9.00 – 1.00

Barrow 01229 811811

Ulverston 01229 588111

Grange 015395 33316

Kendal 01539 734455

Milnthorpe 015395 62044