



**POOLE
TOWNSEND**

Victoria Road, Ulverston

£395,000

4 1 3



- Fantastic Family Home
- Sought After Location
- Private Rear Patio Area
- Freehold
- Walk In Ready Home
- 4 Bedrooms
- Walking Distance To Town Centre
- Downstairs W/C
- Basement Currently Used As Laundry Room
- Council tax band D



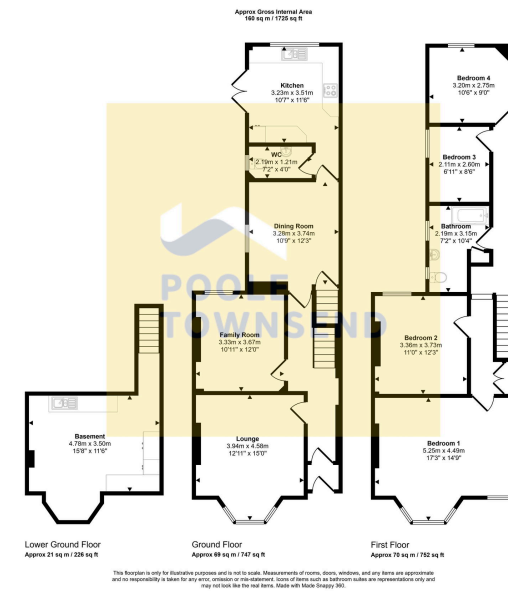

This is a stunning family home that has been beautifully updated and finished with a nice balance between period features and modern décor/fittings. The property's generous accommodation features three reception areas, ground floor WC/cloakroom and modern kitchen that has an outlook into Lightburn Park and beyond to Hoad Hill and Sir John Barrow' monument which is visible above the rooftops. The landing is split-level and provides access to the four bedrooms and 3-piece bathroom. The basement room has also been renovated and fitted with a range of units to create a laundry room. The enclosed patio style garden offers a space to relax and gaze across the park.

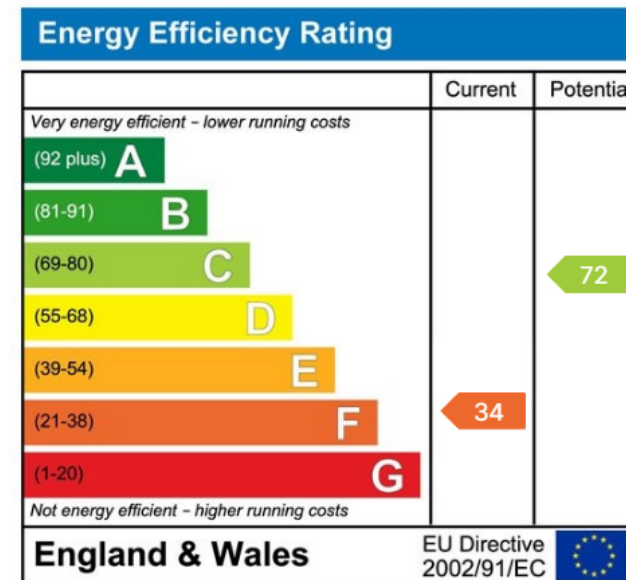

Visit us at
www.pooletownsend.co.uk
enquiries@pooletownsend.co.uk

We are open
 Monday – Friday 9.00 – 5.00
 Saturday 9.00 – 1.00

Barrow 01229 811811
 Ulverston 01229 588111
 Grange 015395 33316
 Kendal 01539 734455
 Milnthorpe 015395 62044