



**POOLE
TOWNSEND**

Little Croft, Weint Lane, Great Urswick

£260,000

🛏️ 2 🚿 1 🚗 1



- Council tax band C
- Freehold
- No upper chain
- Off road parking
- Sought after village location
- Gardens with decking and a pond
- 2 double bedrooms
- Stylish kitchen
- Bright and airy open plan living
- Beautiful detached bungalow





Approx Gross Internal Area
59 sq m / 639 sq ft

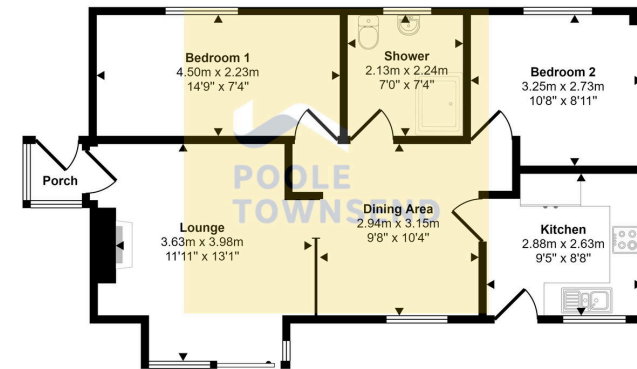

Floorplan

This floorplan is only for illustrative purposes and is not to scale. Measurements of rooms, doors, windows, and any items are approximate and no responsibility is taken for any error, omission or mis-statement. Icons of items such as bathroom suites are representations only and may not look like the real items. Made with Made Snappy 360.

This beautifully presented bungalow is nestled away within the picturesque South Lakes village of Great Urswick. The renovated property offers split-level, open plan lounge/dining room with sliding doors accessing the sunny garden. There are two double bedrooms, a modern fitted kitchen and a three-piece shower room. The property also features private driveway parking, a gas-fired central heating system, double glazing and no upper chain.

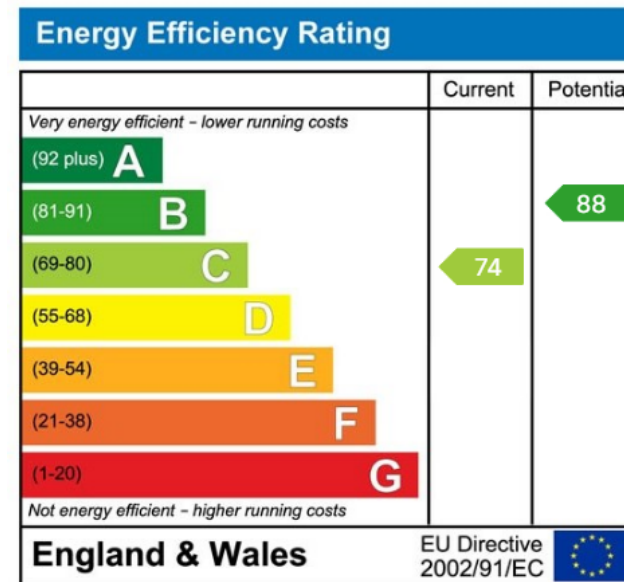

Visit us at
www.pooletownsend.co.uk
enquiries@pooletownsend.co.uk

We are open
 Monday – Friday 9.00 – 5.00
 Saturday 9.00 – 1.00

Barrow 01229 811811
 Ulverston 01229 588111
 Grange 015395 33316
 Kendal 01539 734455
 Milnthorpe 015395 62044