





**POOLE
TOWNSEND**

Bay View Road, Baycliff, Ulverston, Cumbria, LA12 9ST
Offers In Region Of £380,000

 4  2  1



- Well presented family home
- Spacious open plan kitchen/ diner
- 4 double bedrooms (main en-suite)
- Sea Views
- Freehold
- Sought after coastal village location
- Lovely views to front and rear
- Driveway and garage
- Gardens front and rear
- Council tax band E



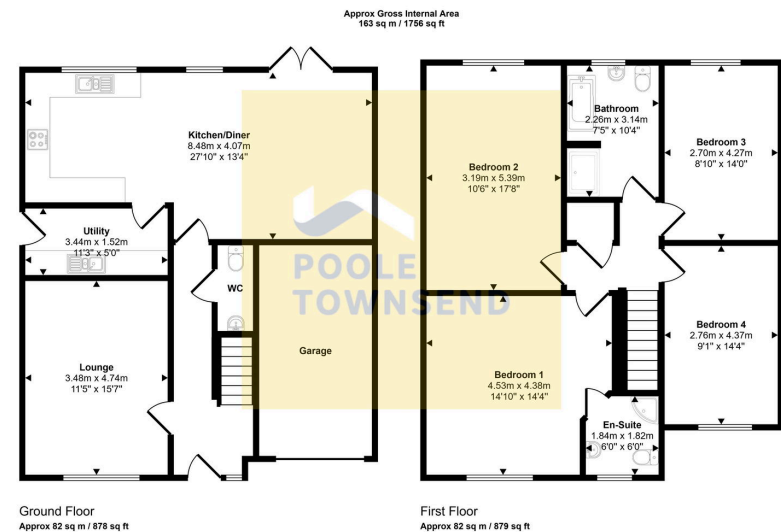

Centrally located in the desirable coastal village of Baycliff, this fine family home offers generous sized accommodation which includes a family lounge, an open plan kitchen with dining area alongside, ground floor utility room and a separate WC, four double bedrooms with an en-suite shower room to the master bedroom plus a four piece family bathroom. The property features all the benefits of a modern constructed home, in addition to a great view onto a field behind and to the front you can enjoy glimpses of Morecambe Bay and nearby fields that surround the village. Private driveway parking and an integral garage are also included.

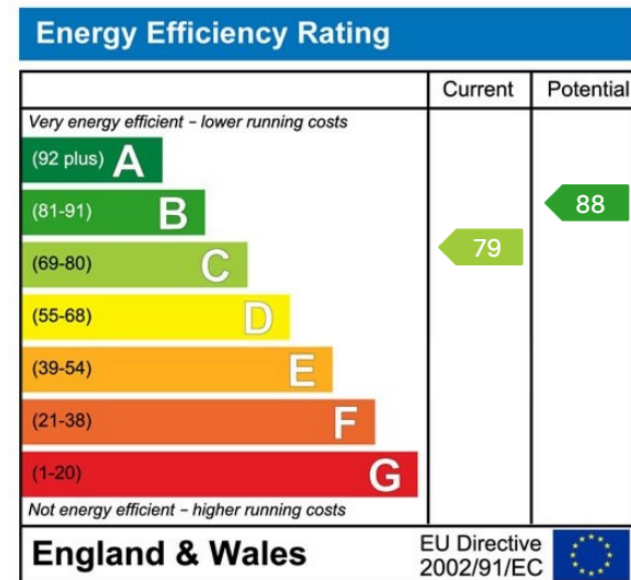

Visit us at
www.pooletownsend.co.uk
enquiries@pooletownsend.co.uk

We are open
 Monday – Friday 9.00 – 5.00
 Saturday 9.00 – 1.00

Barrow 01229 811811
 Ulverston 01229 588111
 Grange 015395 33316
 Kendal 01539 734455
 Milnthorpe 015395 62044