



**POOLE  
TOWNSEND**



## 9 Trinity Court New Church Lane

£200,000

🛏 2 🍽 2 🛋 1





- Fantastic Two Bedroom Maisonette
- Allocated Parking
- Walking Distance To Town
- Master Bedroom With En-Suite
- Council Tax Band B
- Original Features Through Out
- No Upper Chain
- Close To Transport Links
- Leashold
- Communal Gardens



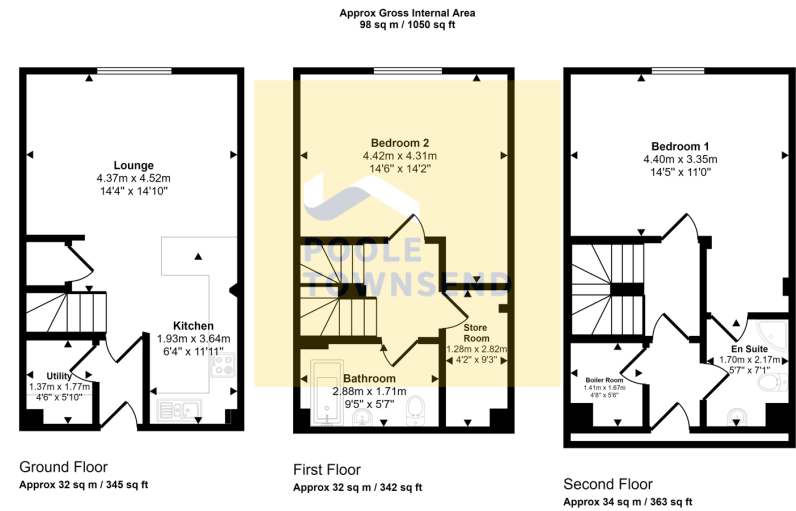

Modern 2 bed apartment over 3 floors offering flexible living space within just a few minutes walk from the festival town of Ulverston, and only a short drive to the edge of the Lake District. Must be viewed to be appreciated. Quality finishes throughout with landscaped shared gardens and private parking. Please note this property cannot be used as a holiday let.

Visit us at  
[www.pooletownsend.co.uk](http://www.pooletownsend.co.uk)  
[enquiries@pooletownsend.co.uk](mailto:enquiries@pooletownsend.co.uk)

We are open  
 Monday – Friday 9.00 – 5.00  
 Saturday 9.00 – 1.00

Barrow 01229 811811  
 Ulverston 01229 588111  
 Grange 015395 33316  
 Kendal 01539 734455  
 Milnthorpe 015395 62044