



**POOLE  
TOWNSEND**

Mountbarrow Road, Ulverston, LA12 9NL

£300,000

3 1 1



- Fantastic 3 Bedroom Semi Detached Bungalow
- Close To Local Amenities And Transport Links
- Front And Rear Gardens
- Council Tax Band D
- Conservatory
- Sought After Location
- Drive And Single Garage
- Freehold
- No Upper Chain



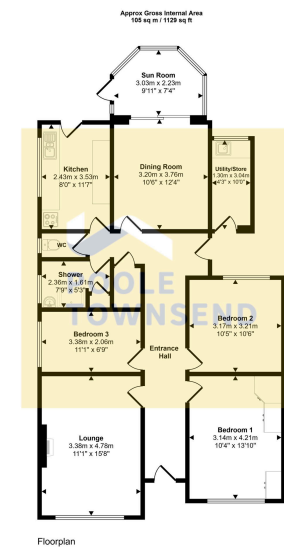

This floorplan is only for illustrative purposes and is not to scale. Measurements of rooms, doors, windows, and any items are approximate and no responsibility is taken for any error, omission or misstatement. Lines of items such as bathroom suites are representations only and may not look like the real items. Made with Maple Group 360.

This nicely proportioned bungalow offers well-appointed accommodation that is all accessible from the central hallway. There are two reception rooms, sun room, kitchen, three bedrooms and a shower room with a separate WC alongside. There is ladder access into a vast loft space that could be developed into further accommodation. There is extensive off-road parking, a garage, garden to the front and rear, GCH and DG. No upper chain.

Visit us at  
[www.pooletownsend.co.uk](http://www.pooletownsend.co.uk)  
[enquiries@pooletownsend.co.uk](mailto:enquiries@pooletownsend.co.uk)

We are open  
 Monday – Friday 9.00 – 5.00  
 Saturday 9.00 – 1.00

Barrow 01229 811811  
 Ulverston 01229 588111  
 Grange 015395 33316  
 Kendal 01539 734455  
 Milnthorpe 015395 62044