





# Sawrey Court, Broughton In Furness

£175,000

🛏 2 🍳 1 🛋 1





- Well presented first floor apartment
- Spacious accommodation throughout
- Suited to a range of buyers
- Bright and airy rooms
- Leasehold
- Popular village location with shops, pubs and restaurant
- 2 double bedrooms
- Move in ready
- Local occupancy clause applies
- Council tax band B



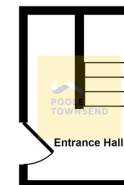

Ground Floor  
Approx 5 sq m / 57 sq ft

This floorplan is only for illustrative purposes and is not to scale. Measurements of rooms, doors, windows, and any items are approximate and no responsibility is taken for any error, omission or mis-statement. Icons of items such as bathroom suites are representations only and may not look like the real items. Made with Made Snappy 360.

This well presented first floor apartment is centrally located within Broughton, a sought-after town on the West Cumbrian coast with great walks on your doorstep. The property will appeal to a range of buyers and is in move in ready condition. The accommodation itself comprises; two double bedrooms, a lovely size lounge/dining room, kitchen and a three-piece bathroom. Viewing is highly recommended.

This property has a local occupancy clause attached. Must have lived and worked in Cumbria for at least 3 years.

Visit us at  
[www.pooletownsend.co.uk](http://www.pooletownsend.co.uk)  
[enquiries@pooletownsend.co.uk](mailto:enquiries@pooletownsend.co.uk)

We are open  
Monday – Friday 9.00 – 5.00  
Saturday 9.00 – 1.00

Barrow 01229 811811  
Ulverston 01229 588111  
Grange 015395 33316  
Kendal 01539 734455  
Milnthorpe 015395 62044