



**POOLE
TOWNSEND**

Canal Foot, Ulverston, detached bungalow with planning permission for a 4 bed detached house

£290,000

🛏 2 🚿 1 🛋 1



- Opportunity to build your own home with stunning views
- Chain Free
- Fantastic Sought After Location
- Views Across Morcambe Bay
- Off Road Parking
- Gardens
- Freehold



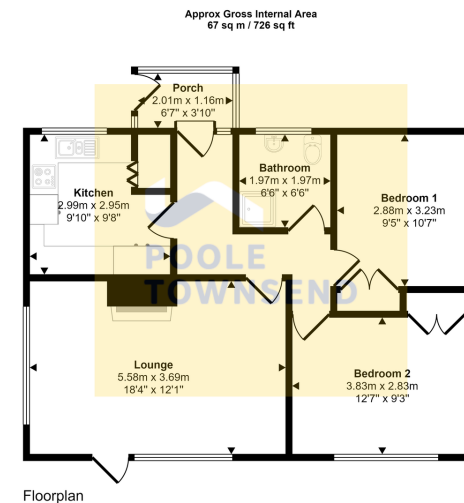

This floorplan is only for illustrative purposes and is not to scale. Measurements of rooms, doors, windows, and any items are approximate and no responsibility is taken for any error, omission or mis-statement. Icons of items such as bathroom suites are representations only and may not look like the real items. Made with Made Snappy 360.

A fantastic opportunity to purchase a property in a very desirable location. This has the benefit of having granted planning permission for a detached 4 bedroom house and garage. The original dwelling could be renovated or demolished to build new. This property is a must see as the views across Morecambe Bay are stunning.

Visit us at
www.pooletownsend.co.uk
enquiries@pooletownsend.co.uk

We are open
 Monday – Friday 9.00 – 5.00
 Saturday 9.00 – 1.00

Barrow 01229 811811
 Ulverston 01229 588111
 Grange 015395 33316
 Kendal 01539 734455
 Milnthorpe 015395 62044