



**POOLE  
TOWNSEND**

# Incline Foot Cottages, Kirkby In Furness

£285,000

🛏️ 2 🪑 1 🚗 2



- Walk In Ready Home
- Bright Modern Kitchen Area
- Driveway Parking For Multiple Cars
- Beautiful Countryside Views
- Council Tax Band C
- Lounge And Separate Dining Room
- Loft Room Ideal For Development
- Raised Patio Area To The Rear
- Freehold



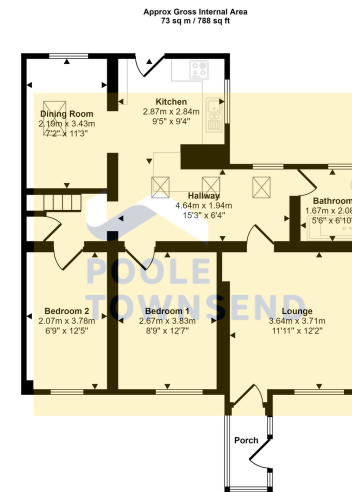

Floorplan

This floorplan is only for illustrative purposes and is not to scale. Measurements of rooms, doors, windows, and any items are approximate and no responsibility is taken for any error, omission or mis-statement. Items of items such as bathroom suites are representations only and may not look like the real items. Made with Made Spruppy 300.

A unique property set in the ever desirable village of Kirkby-in-Furness. Historically used as an office for the nearby quarry, the property has been converted into a charming semi-detached bungalow. Comprising of a lounge, kitchen, dining room, 2 bedrooms and bathroom the property would suit a variety of purchasers such as first time buyers, couples, investors or anyone looking to downsize. Externally the property has a patio garden and off road parking for 4/5 cars. Viewings highly recommended.

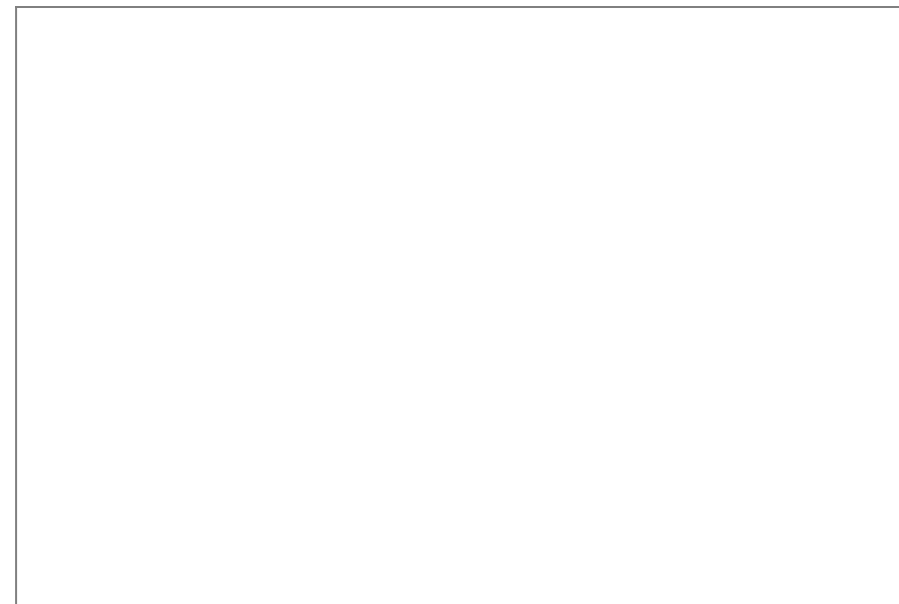

Visit us at  
[www.pooletownsend.co.uk](http://www.pooletownsend.co.uk)  
[enquiries@pooletownsend.co.uk](mailto:enquiries@pooletownsend.co.uk)

We are open  
 Monday – Friday 9.00 – 5.00  
 Saturday 9.00 – 1.00

Barrow 01229 811811  
 Ulverston 01229 588111  
 Grange 015395 33316  
 Kendal 01539 734455  
 Milnthorpe 015395 62044