



**POOLE
TOWNSEND**

68 Mountbarrow Road

£350,000

4 1 2



- Beautifully presented family home
- Sunny conservatory
- Sought after location
- Attractive gardens to front and rear
- Off road parking
- Open plan living
- Light and bright modern kitchen
- 4 double bedrooms
- Freehold
- Council tax band D



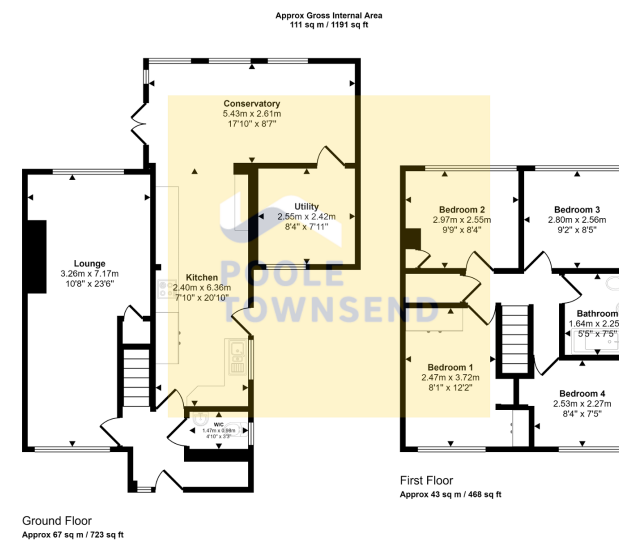

A modern link detached family home which has been extended to create a fantastic living space throughout. Beautifully presented this property is ready for a family to move straight in. Set in a desirable area of Ulverston, the property benefits from contemporary living space to the ground floor. Upstairs there are 4 double bedrooms and family bathroom. Externally the property has front and rear gardens and off road parking. The garage has been converted to provide laundry room and storage area.

Visit us at
www.pooletownsend.co.uk
enquiries@pooletownsend.co.uk

We are open
 Monday – Friday 9.00 – 5.00
 Saturday 9.00 – 1.00

Barrow 01229 811811
 Ulverston 01229 588111
 Grange 015395 33316
 Kendal 01539 734455
 Milnthorpe 015395 62044