



**POOLE
TOWNSEND**

Dorchester Crescent, Ulverston, LA12 9LP

£250,000

3 1 1



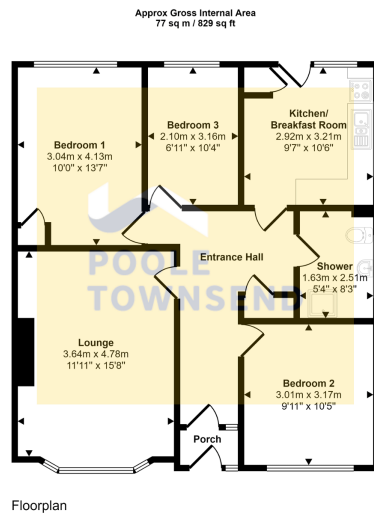

This floorplan is only for illustrative purposes and is not to scale. Measurements of rooms, doors, windows, and any items are approximate and no responsibility is taken for any error, omission or mis-statement. Items such as bathroom suites are representations only and may not look like the real items. Made with Made Snappy 360.



Situated in a lovely cul-de-sac location and just off the local bus route, this three-bedroom bungalow provides nicely laid out accommodation that benefits from a modern gas-fired boiler and central heating radiators, UPVC framed double glazed windows and no upper chain. The central hallway leads to all the living accommodation that includes; a lovely size lounge that overlooks the front garden, kitchen with breakfast area, three bedrooms including two double rooms plus a shower room. There is private driveway leading to a detached garage plus areas of garden to the front and rear.

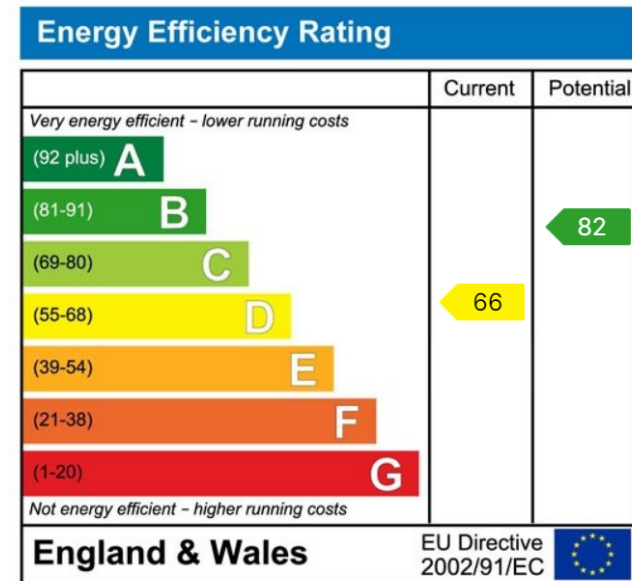

Visit us at
www.pooletownsend.co.uk
enquiries@pooletownsend.co.uk

We are open
 Monday – Friday 9.00 – 5.00
 Saturday 9.00 – 1.00

Barrow 01229 811811
 Ulverston 01229 588111
 Grange 015395 33316
 Kendal 01539 734455
 Milnthorpe 015395 62044