



**POOLE  
TOWNSEND**

# Buxton Place, Ulverston, LA12 7EF

£160,000

1 1 1



- Well presented terraced house
- Open plan living area
- 1 double bedroom
- Ideal for those looking for a holiday home/let
- No upper chain
- Great town centre location
- Close to shops restaurants and pubs
- Move In ready
- Freehold
- Council tax band A





Approx Gross Internal Area  
33 sq m / 352 sq ft

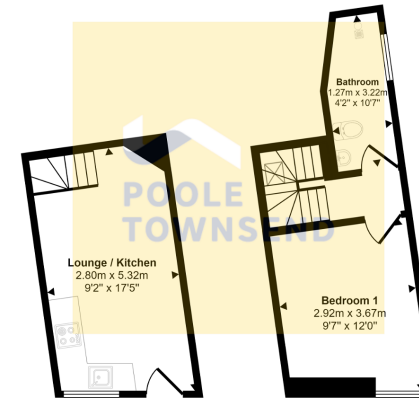

Ground Floor  
Approx 14 sq m / 154 sq ft

First Floor  
Approx 18 sq m / 197 sq ft

This floorplan is only for illustrative purposes and is not to scale. Measurements of rooms, doors, windows, and any items are approximate and no responsibility is taken for any error, omission or mis-statement. Icons of items such as bathroom suites are representations only and may not look like the real items. Made with Made Snappy 360.

Nestled away within the centre of this vibrant market town, this property benefits from convenient access to all the central amenities Ulverston has to offer. The stylish accommodation extends over 2 floors including open plan Lounge / Kitchen to the ground floor and Bathroom and bedroom to the first floor. Ideal for a range of buyers. No upper chain.

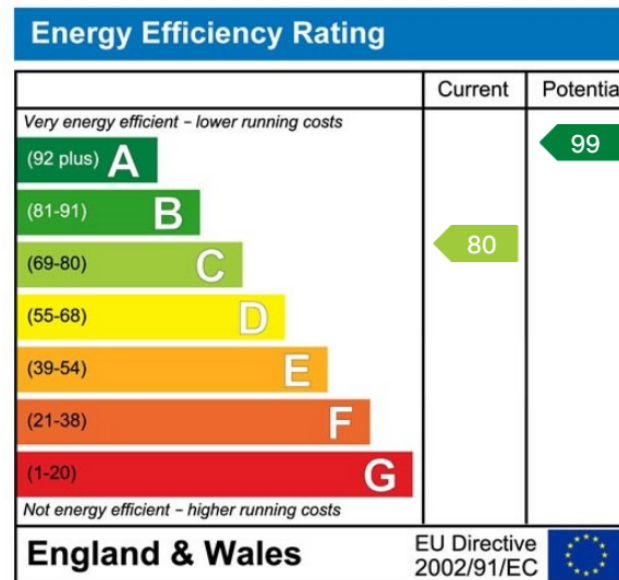

Visit us at  
[www.pooletownsend.co.uk](http://www.pooletownsend.co.uk)  
[enquiries@pooletownsend.co.uk](mailto:enquiries@pooletownsend.co.uk)

We are open  
 Monday – Friday 9.00 – 5.00  
 Saturday 9.00 – 1.00

Barrow 01229 811811  
 Ulverston 01229 588111  
 Grange 015395 33316  
 Kendal 01539 734455  
 Milnthorpe 015395 62044