



**POOLE  
TOWNSEND**

# Long Lane, Stainton With Adgarley, Barrow-in-furness, LA13 0NH

Offers In Region Of £475,000

4 1 3



- Beautifully presented family home
- 3 reception rooms
- Stylish kitchen
- 4 bedrooms
- Ideal property for working from home
- Garage and off road parking
- Landscaped gardens
- Lovely open views
- Freehold
- Council tax band E



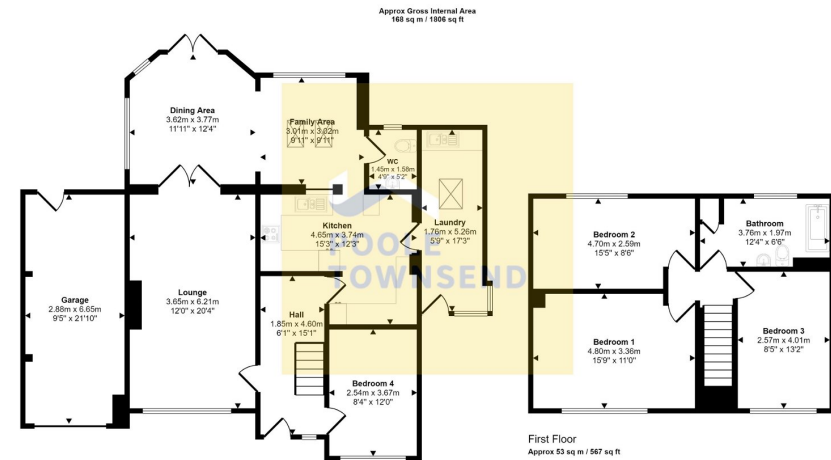

Ground Floor  
Approx 115 sq m / 1238 sq ft

First Floor  
Approx 53 sq m / 567 sq ft

This floorplan is only for illustrative purposes and is not to scale. Measurements of rooms, doors, windows, and any items are approximate and no responsibility is taken for any error, omission or mis-statement. Icons of items such as bathroom suites are representations only and may not look like the real items. Made with Made Snappy 300.

This immaculately presented family home is beautifully situated alongside the village green with lovely open views. The property's accommodation is spacious and has also been extended to provide the opportunity to also work from home. The versatile ground floor living space includes a generous size lounge, with separate dining room and open plan family room with access to the rear garden, W/C, kitchen, home office/ utility room and bedroom 4 which would be ideal for purchasers needing a ground floor bedroom. The first floor has three double bedrooms and a bathroom. There is an attached garage with gated driveway to the front garden alongside more spacious garden to the rear.

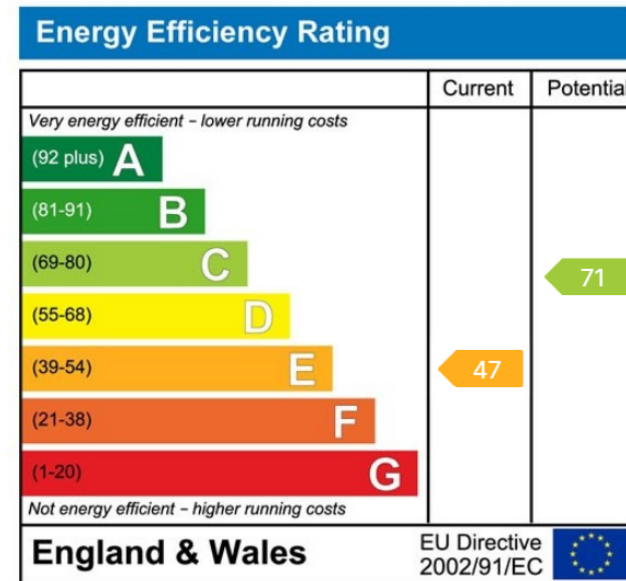

Visit us at  
[www.pooletownsend.co.uk](http://www.pooletownsend.co.uk)  
[enquiries@pooletownsend.co.uk](mailto:enquiries@pooletownsend.co.uk)

We are open  
 Monday – Friday 9.00 – 5.00  
 Saturday 9.00 – 1.00

Barrow 01229 811811  
 Ulverston 01229 588111  
 Grange 015395 33316  
 Kendal 01539 734455  
 Milnthorpe 015395 62044