



**POOLE
TOWNSEND**

Ulpha, Broughton-in-furness, LA20 6DT

Offers In Region Of £750,000

🛏️ 6 🚿 3 🛋️ 3



- Absolutely stunning detached family home
- Beautifully located in The Lake District National Park
- Spacious accommodation throughout
- Approximately 0.9 of an acre of land
- 6 good sized bedrooms
- 3 bathrooms
- Attached workshop and wood store
- Freehold
- Roof terrace with open views
- Council tax band G



Nestling within the picturesque Lake District National Park Low Birks is a stunning property which features extensive gardens encompassing a wooded area and orchard. Many of the property's rooms enjoy beautiful views into the valley, woodland, hills and fells. This delightful accommodation is spacious and well proportioned throughout offering 6 bedrooms with all but one of these rooms being double or larger. There is a stunning open plan kitchen that displays a wealth of timber beams throughout the vaulted ceiling and also has access into the garden. The principle lounge enjoys amazing views with the best of those being from the roof terrace. There is a second lounge to the lower ground floor level with an overhead mezzanine area providing access to the main accommodation. There are two family bathrooms plus a shower room and utility area. Externally is an attached workshop, log store and private parking.

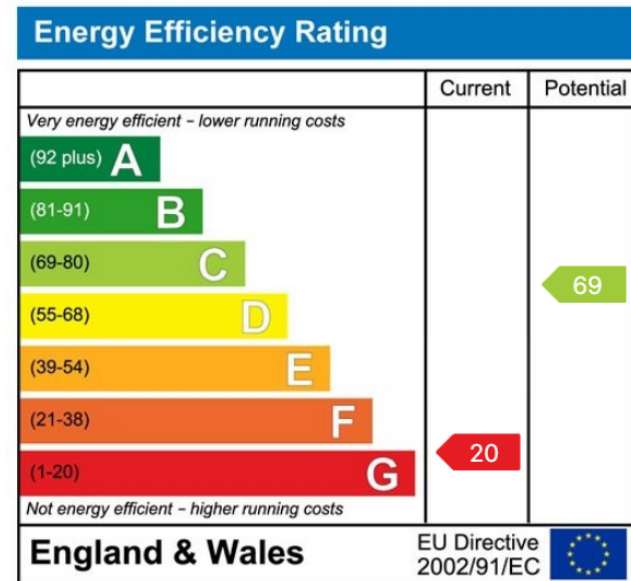
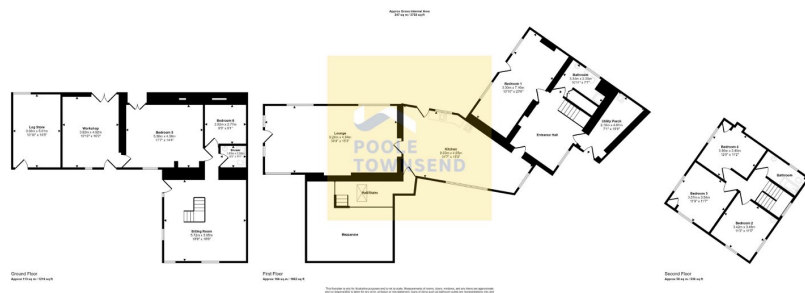

Visit us at
www.pooletownsend.co.uk
enquiries@pooletownsend.co.uk

We are open
 Monday – Friday 9.00 – 5.00
 Saturday 9.00 – 1.00

Barrow 01229 811811
 Ulverston 01229 588111
 Grange 015395 33316
 Kendal 01539 734455
 Milnthorpe 015395 62044