



**POOLE
TOWNSEND**

Park Road, Swarthmoor, Ulverston, LA12 0HJ

£190,000

🛏️ 2 🚿 1 🚗 1



- Freehold
- Council Tax Band D
- Fantastic 2 Bedroom Semi Detached Bungalow
- Walk-In-Ready
- Open Plan Kitchen Lounge
- Low Maintenance Rear Yard



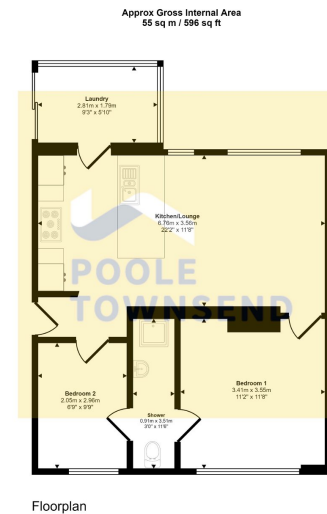

This floorplan is only for illustrative purposes and is not to scale. Measurements of rooms, doors, windows, and any items are approximate and no responsibility is taken for any error, omission or mis-statement. Icons of items such as bathroom suites are representations only and may not look like the real items. Made with Made Snappy 360.

This charming bungalow offers a cosy and contemporary feel, offering a fabulous open plan living area with a stylish kitchen with breakfast bar, a glazed laundry, 2 bedrooms and a Jack 'n' Jill shower room. There is an enclosed garden to the front and to the rear with a large outbuilding. The accommodation benefits from a gas central heating system and UPVC DG throughout. A lovely property in a desirable location. ** Local occupancy restrictions apply **

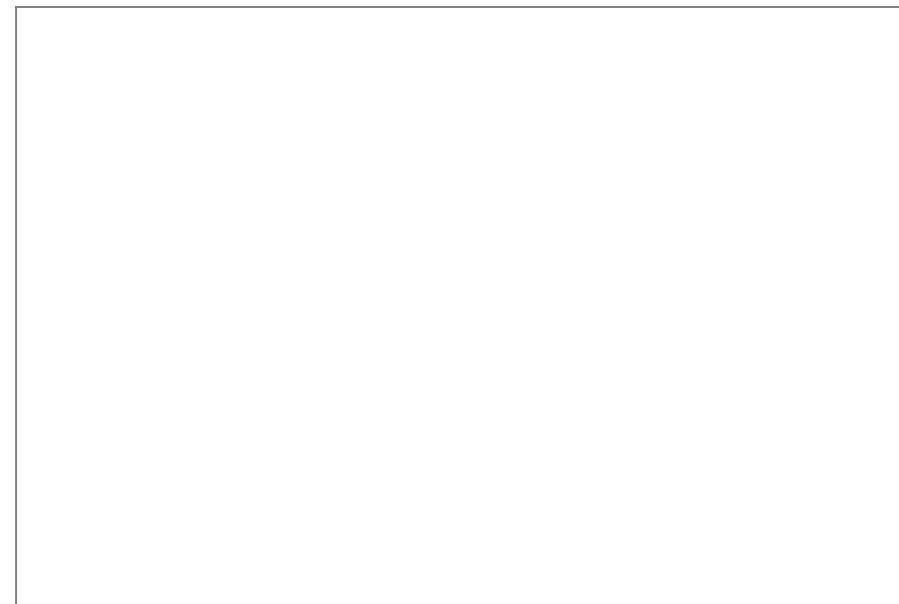

Visit us at
www.pooletownsend.co.uk
enquiries@pooletownsend.co.uk

We are open
 Monday – Friday 9.00 – 5.00
 Saturday 9.00 – 1.00

Barrow 01229 811811
 Ulverston 01229 588111
 Grange 015395 33316
 Kendal 01539 734455
 Milnthorpe 015395 62044