



**POOLE  
TOWNSEND**



Brook Street, Barrow-In-Furness, LA13 9SY

£79,950

🛏 2 🚿 1 🛋 1





This mid-terrace property is situated in a popular location with younger buyers and investors/landlords. The property's accommodation comprises; a lounge, fitted kitchen with space for a dining table, ground floor WC, two bedrooms and a wet room. The property has UPVC framed double glazing throughout, a gas-fired central heating system, a garage and an enclosed yard. No upper chain.

### Location

What3Words///season.jump.mutual

### Description

Located in a popular area which is convenient for the leisure centre, Barrow Park, schools and shops etc.

This property will appeal to buyers searching for a home that can be updated and decorated to meet their own personal taste.

The living space comprises of a lounge which is accessed through the entrance vestibule. There is a open fronted gas fire to the front of the chimney breast and a concertina style door leading to the central staircase which also has a useful storage cupboard beneath that is accessed from the kitchen.

The kitchen has modern fitted units, drawers and glass fronted cabinets. There is a single drainer sink set within the worktop and a halogen style hob with extractor hood fitted to the wall above. There is a low-level fan assisted oven with grill, plumbing for a washing machine and space for an upright fridge freezer. The gas boiler is in the cupboard to the rear of the room.

Beyond the kitchen is a small rear hall where there is an external door leading into the yard and a second door taking you into the ground floor WC.

The landing has separate access to the wet room and to both of the double bedrooms. The larger bedroom is at the front of the house, benefiting from a range of wardrobe furniture, drawers and a dressing table.

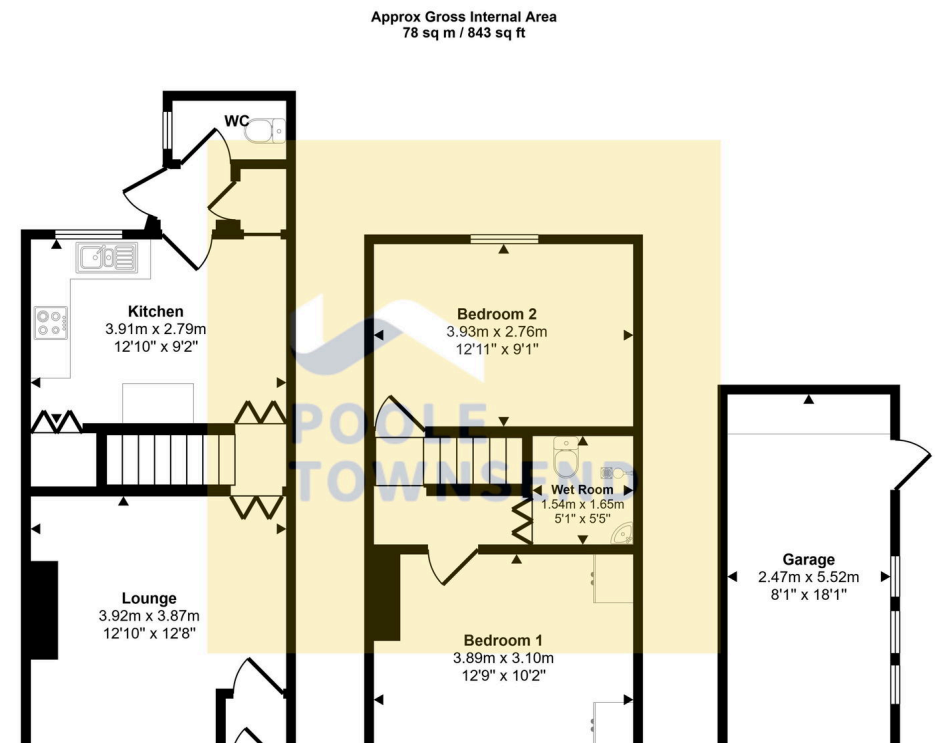



- Mid terrace property
- Situated in a popular location
- Lounge area
- Fitted kitchen space
- Ground floor WC
- Two bedrooms and a wet room
- Garage and enclosed yard
- UPVC framed double glazing
- Gas-fired central heating system
- No upper chain system

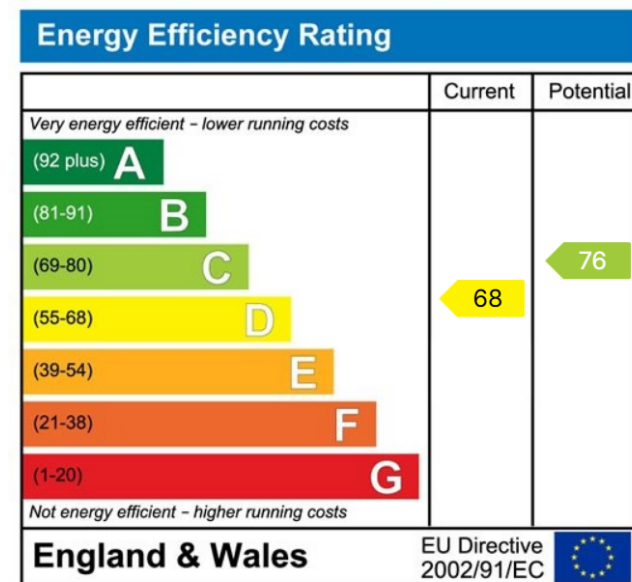

Visit us at  
[www.pooletownsend.co.uk](http://www.pooletownsend.co.uk)  
[enquiries@pooletownsend.co.uk](mailto:enquiries@pooletownsend.co.uk)

We are open  
 Monday – Friday 9.00 – 5.00  
 Saturday 9.00 – 1.00

Barrow 01229 811811  
 Ulverston 01229 588111  
 Grange 015395 33316  
 Kendal 01539 734455  
 Milnthorpe 015395 62044