



**POOLE
TOWNSEND**

Spindrift Close, Askam-In-Furness, LA16 7HY

£310,000

🛏 2 🚿 2 🛋 1



- Detached bungalow with stunning views
- Generous sized kitchen
- Family bathroom
- Driveway parking
- Double glazing
- Spacious accommodation
- Two double bedrooms
- Attached garage
- Easy to manage garden
- No upper chain



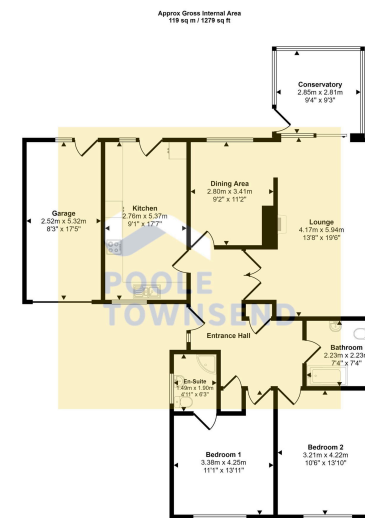

Floorplan

This floorplan is only for illustrative purposes and is not to scale. Measurements of rooms, doors, windows, and any items are approximate and no responsibility is taken for any error, omission or misstatement. Sizes of items such as bathroom suites are representative only and may not look like the real items. Made with Magic Shapely 360.

NEW ** Situated in the ever popular coastal village of Askam, this detached bungalow also enjoys the benefit of being situated in a cul-de-sac, especially as this property backs onto the local beach with stunning views across the estuary to the West Cumbrian coastline that extends across to the Lake District mountain range. The accommodation is spacious and includes a lounge with sliding doors accessing the conservatory and open access into the dining room. There is also a generous sized kitchen, two double bedrooms (one en-suite shower room) plus a family bathroom. Other features to note about the property are the attached garage with driveway parking for at least two cars, easy to manage garden areas, gas-fired central heating system, double glazing and no upper chain.

Visit us at
www.pooletownsend.co.uk
enquiries@pooletownsend.co.uk

We are open
 Monday – Friday 9.00 – 5.00
 Saturday 9.00 – 1.00

Barrow 01229 811811
 Ulverston 01229 588111
 Grange 015395 33316
 Kendal 01539 734455
 Milnthorpe 015395 62044