



**POOLE
TOWNSEND**

Skiddaw Gardens, Barrow-in-furness, LA14 4LZ

£280,000

🛏 2 🚿 1 🛋 2



- Corner plot detached bungalow
- Dining and kitchen area
- Three-piece bathroom
- Attached garage
- Gas-fired central heating system
- Dual aspect lounge
- Two double bedrooms
- Private driveway parking
- UPVC framed glazing
- No upper chain system



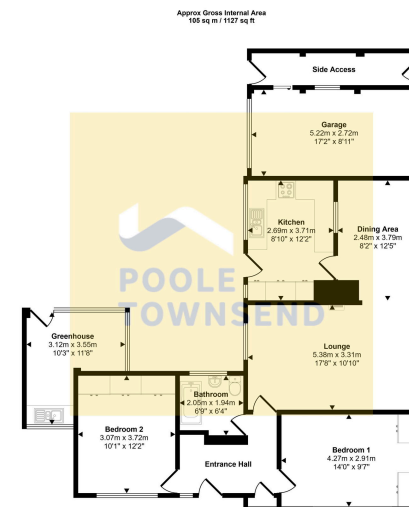

Floorplan

This floorplan is only for illustrative purposes and is not to scale. Measurements of rooms, doors, windows, and any items are approximate and no responsibility is taken for any error, omission or mis-statement. Copies of items such as bathroom suites are representations only and may not look like the real items. Made with Magic Strategy 360.

NEW Situated within the sought after Hawcoat area of town, this detached, true bungalow is set on a corner plot with areas of garden wrapping around the front and side of the property. The accommodation is nicely proportioned and includes a dual aspect lounge, a dining area, kitchen, two double bedrooms (both with fitted furniture) plus a three-piece bathroom. Other points to note about the property are private driveway parking, attached garage, gas-fired central heating system and UPVC framed glazing. No upper chain.

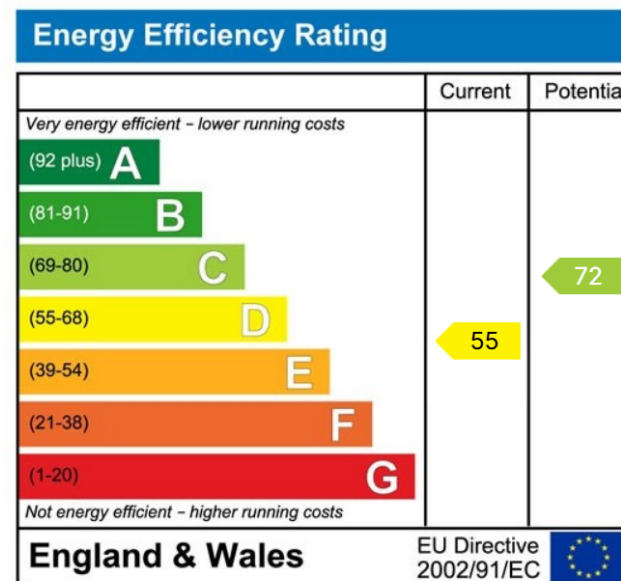

Visit us at
www.pooletownsend.co.uk
enquiries@pooletownsend.co.uk

We are open
 Monday – Friday 9.00 – 5.00
 Saturday 9.00 – 1.00

Barrow 01229 811811
 Ulverston 01229 588111
 Grange 015395 33316
 Kendal 01539 734455
 Milnthorpe 015395 62044