



**POOLE
TOWNSEND**

Belvedere Road, Barrow-in-furness, LA13 0HS

£195,000

🛏️ 2 🚿 1 🛋️ 2



- Located in a desirable area
- 2 Bedrooms
- Shower room
- Rear garden
- Attached utility/washroom area
- Gas-fired central heating system
- Double glazing
- Gated driveway
- Council tax band - C
- No upper chain



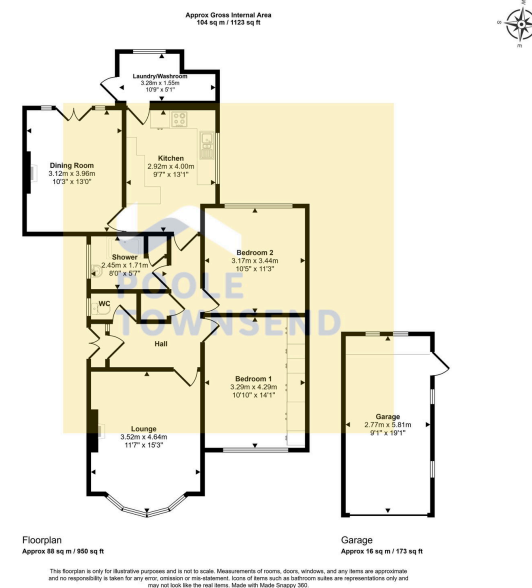

NEW Located in a desirable residential area that is convenient for local amenities, this semi-detached bungalow offers nicely appointed accommodation that would suit a range of buyers. The central hallway leads you to the separate WC, lounge, kitchen, two bedrooms and shower room. Beyond the kitchen is a second reception room that provides the perfect dining space with double doors opening into the rear garden. There is also an attached utility/washroom area that is accessed via the kitchen. The property does require general modernising and updating which will also appeal to buyers. There is a gas-fired central heating system and double glazing throughout, a gated driveway leading to a larger than average detached garage plus easier to manage garden to the front and rear. No upper chain.

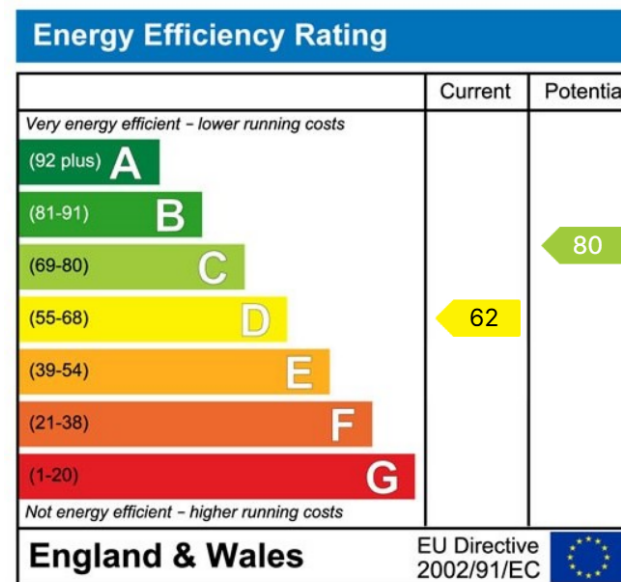

Visit us at
www.pooletownsend.co.uk
enquiries@pooletownsend.co.uk

We are open
 Monday – Friday 9.00 – 5.00
 Saturday 9.00 – 1.00

Barrow 01229 811811
 Ulverston 01229 588111
 Grange 015395 33316
 Kendal 01539 734455
 Milnthorpe 015395 62044