



**POOLE
TOWNSEND**

Robert Street, Barrow-In-Furness, LA14 1EB

£59,950

🛏 2 🚿 1 🛋 2



Situated in the heart of the town, this traditional terraced home offers excellent potential for modernisation, making it an attractive opportunity for investors. The accommodation comprises an open-plan lounge and dining area, a kitchen, two bedrooms, and a bathroom. Additional benefits include UPVC double glazing throughout, a gas-fired central heating system, and an enclosed rear yard with access to a separate utility room.

Directions

For Satnav users enter: LA14 1EB

For what3 words app users enter: basic.gives.start

Location

Robert Street is conveniently located in the town centre, just a short walk from a variety of shops, local bars, and eateries, as well as independent businesses such as hair and beauty salons, newsagents, and an off-licence. A Tesco supermarket is also nearby for everyday essentials. Excellent transport links, including local bus services and the town's railway station, make this an ideal location for commuters.

Description

The property is accessed via on-road parking, with a pedestrian pathway leading to the front door. Stepping inside, you are welcomed into an open-plan lounge and dining area, featuring a staircase to one side that leads to the first-floor accommodation.

Adjacent to the lounge, the kitchen is fitted with a range of sleek white gloss storage units and a three-sided worktop, incorporating a single drainer sink with a mixer tap. There is ample space for a cooker and an upright fridge/freezer. An external door leads to the enclosed rear yard, which provides access to a utility room and a gated rear service lane. The utility room is equipped with additional storage units, a single worktop, and plumbing for a washing machine

The first-floor accommodation consists of two bedrooms and a bathroom. The master bedroom is a spacious double bedroom with



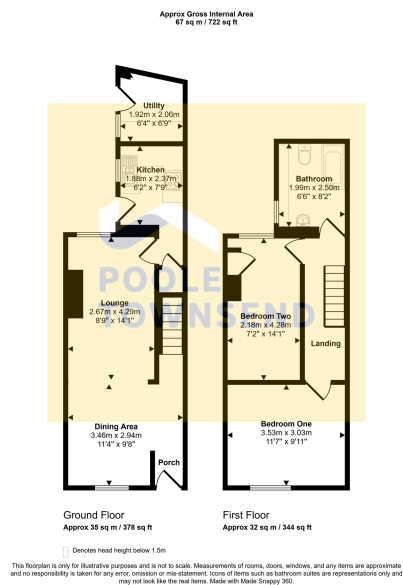

- Mid Terraced Home
- Kitchen
- Three Piece Bathroom
- Ideal Rental Or First Time Buy
- FREEHOLD
- Lounge
- Two Bedrooms
- Town Centre Location
- NO CHAIN
- Council Tax Band -



Visit us at
www.pooletownsend.co.uk
enquiries@pooletownsend.co.uk

We are open
 Monday – Friday 9.00 – 5.00
 Saturday 9.00 – 1.00

Barrow 01229 811811
 Ulverston 01229 588111
 Grange 015395 33316
 Kendal 01539 734455
 Milnthorpe 015395 62044