



**POOLE
TOWNSEND**

Mill Bank, Barrow-in-furness, LA14 4AP

£69,950

🛏 2 🚿 1 🛋 1



- First floor flat
- Dual aspect lounge
- Two bedrooms
- Separate WC and cloak area
- UPVC framed double glazing
- Superbly proportioned
- Modern fitted kitchen
- Modern fitted bathroom
- Gas-fired central heating system



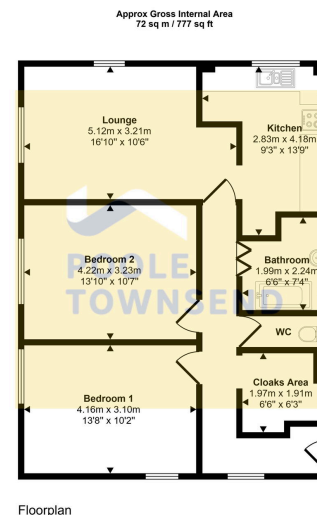

This floorplan is only for illustrative purposes and is not to scale. Measurements of rooms, doors, windows, and any items are approximate and no responsibility is taken for any error, omission or mis-statement. Icons of items such as bathroom suites are representations only and may not look like the real items. Made with Made Snappy 360.

NEW This first floor flat sits within a small block of purpose-built properties in the popular Ormsgill area of Barrow. The building is accessed via an intercom system that provides added convenience and security. The accommodation is superbly proportioned and features a generous sized, dual aspect lounge and a modern fitted kitchen, two impressive bedrooms that can comfortably accommodate a king-size bed and other furnishings, a modern fitted bathroom, separate WC and a cloaks area. Other notable features about this property include the gas-fired central heating system with a modern boiler, UPVC framed double glazing throughout and a much higher than average EPC rating of band C.

Visit us at
www.pooletownsend.co.uk
enquiries@pooletownsend.co.uk

We are open
 Monday – Friday 9.00 – 5.00
 Saturday 9.00 – 1.00

Barrow 01229 811811
 Ulverston 01229 588111
 Grange 015395 33316
 Kendal 01539 734455
 Milnthorpe 015395 62044