

Summerhill Gardens, Barrow-in-furness, LA14 4LD

£240,000

 2  1  1



Situated in a lovely cul-de-sac location in the popular Hawcoat area of town, this semi-detached bungalow offers nicely appointed accommodation that has benefited from a conservatory extension to the rear. The near level plot includes garden to the front, side and rear, a large gated driveway and a useful garage sized store. The accommodation is all accessed from a central hall where there is ladder access into a spacious loft that has potential for development. There is a multi-aspect lounge, fitted kitchen, 2 bedrooms, shower room and double glazed conservatory. There is a gas-fired central heating system, double glazing and no upper chain.

Key Features

- Popular Residential Location
- Ample Off Road Parking
- Detached Garage
- Double Glazing
- Council Tax Band B
- Generous Size Plot
- Gardens Front & Rear
- Gas Central Heating
- No Upper Chain
- EPC TBC

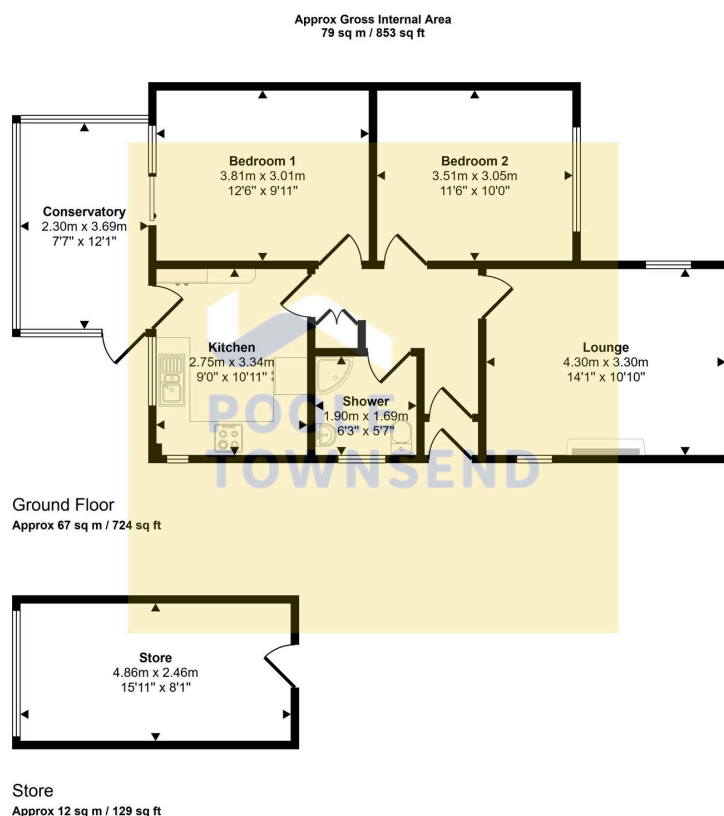

This floorplan is only for illustrative purposes and is not to scale. Measurements of rooms, doors, windows, and any items are approximate and no responsibility is taken for any error, omission or mis-statement. Icons of items such as bathroom suites are representations only and may not look like the real items. Made with Made Snappy 360.