



**POOLE
TOWNSEND**

Abbotsmead Approach, Barrow-in-Furness, LA13 0BS

£160,000

3 1 2



- Upgraded shower room
- Open plan garden to the front
- Enclosed garden to the rear
- Council Tax Band - A
- UPVC framed double glazing
- 3 Bedrooms
- Modernised kitchen with integrated appliances and solid timber work surfacing
- Conservatory extension to the rear
- 2 Reception rooms
- Popular location



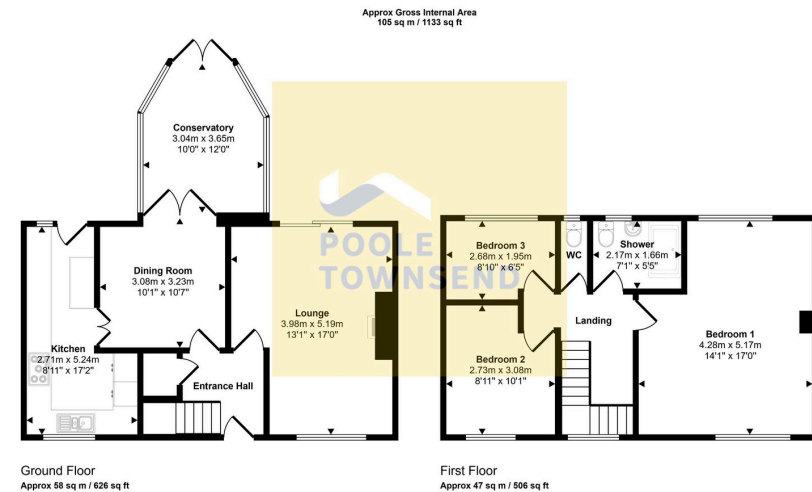

This floorplan is only for illustrative purposes and is not to scale. Measurements of rooms, doors, windows, and any items are approximate and no responsibility is taken for any error, omission or mis-statement. Icons of items such as bathroom suites are representations only and may not look like the real items. Made with Made Snappy 360.

NEW This family home is located in a popular location, just off the local bus route and also within easy reach of schools and shops. The accommodation includes two reception rooms, a conservatory extension to the rear and a smartly modernised kitchen with integrated appliances, integrated condenser dryer and solid timber work surfacing. There are three bedrooms to the first floor, a nicely upgraded shower room and a separate WC alongside. There is open plan garden to the front, an enclosed garden to the rear patio with a lawn, patio and a substantial timber shed. The property also features UPVC framed double glazing.

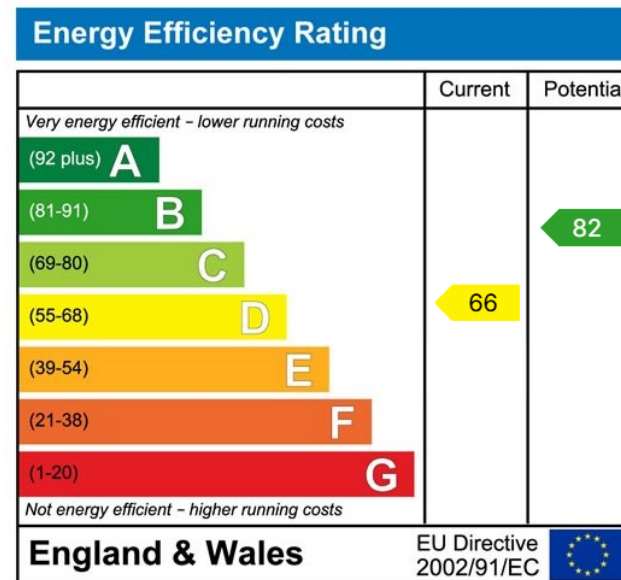

Visit us at
www.pooletownsend.co.uk
enquiries@pooletownsend.co.uk

We are open
 Monday – Friday 9.00 – 5.00
 Saturday 9.00 – 1.00

Barrow 01229 811811
 Ulverston 01229 588111
 Grange 015395 33316
 Kendal 01539 734455
 Milnthorpe 015395 62044