



**POOLE  
TOWNSEND**



# Meadow Chase Crescent, Barrow-in-Furness, LA13 0FA

£330,000

🛏 4 🚿 2 🛋 1





- Lovely family home
- Dining kitchen
- Four bedrooms
- Integrated garage
- Parking to the front
- Generous size rooms throughout
- Ground floor WC
- En-suite shower room
- Garden with a patio



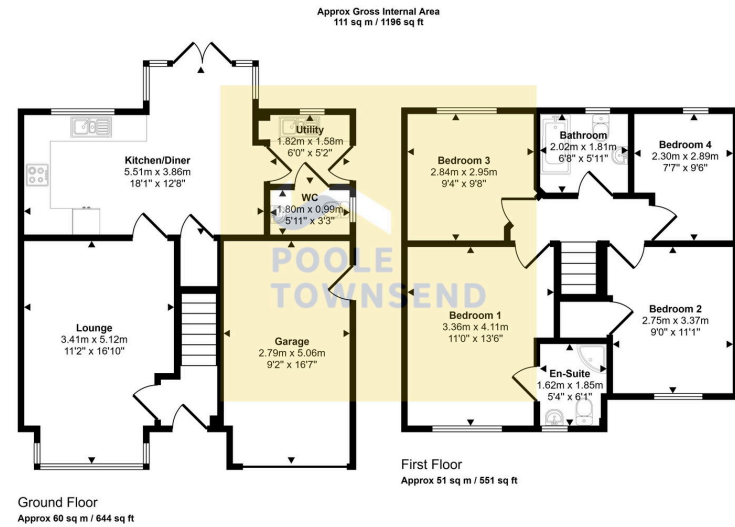

This floorplan is only for illustrative purposes and is not to scale. Measurements of rooms, doors, windows, and any items are approximate and no responsibility is taken for any error, omission or mis-statement. Icons of items such as bathroom suites are representations only and may not look like the real items. Made with Made Snappy 360.

This property would make a lovely family home, featuring generous size rooms throughout, a superb dining kitchen with French doors opening into the garden, a GF WC, family bathroom and an en-suite shower room to one of the four bedrooms. Situated on a popular development in the Beacon Hill area of town, this property also offers an integrated garage with plentiful parking to the front. The garden has been improved further with the additional of an impressive patio with pergola.

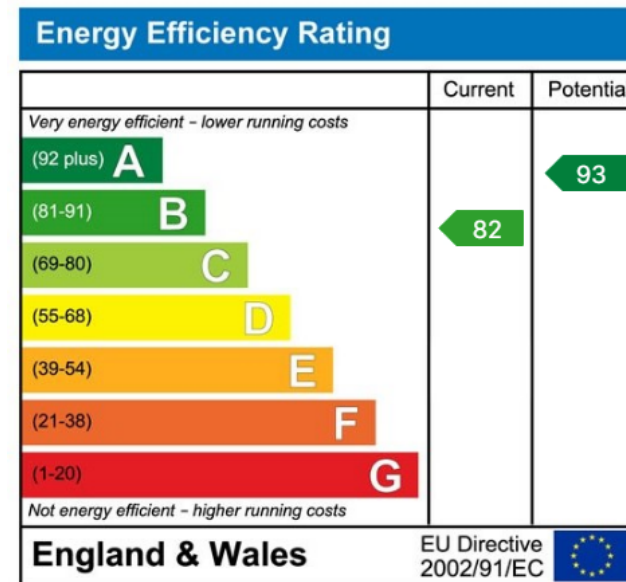

Visit us at  
[www.pooletownsend.co.uk](http://www.pooletownsend.co.uk)  
[enquiries@pooletownsend.co.uk](mailto:enquiries@pooletownsend.co.uk)

We are open  
 Monday – Friday 9.00 – 5.00  
 Saturday 9.00 – 1.00

Barrow 01229 811811  
 Ulverston 01229 588111  
 Grange 015395 33316  
 Kendal 01539 734455  
 Milnthorpe 015395 62044