



**POOLE
TOWNSEND**

Teasdale Road, Walney, Barrow-in-furness, LA14 3SF
£210,000

3 1 2



- Nicely presented, family sized home
- Open-plan living space
- Separate fitted kitchen
- Three piece bathroom
- Tenure: Freehold
- Driveway access to a detached garage
- 3 Bedrooms
- Rear garden
- Easy walk to the local bus route
- Council tax band - B



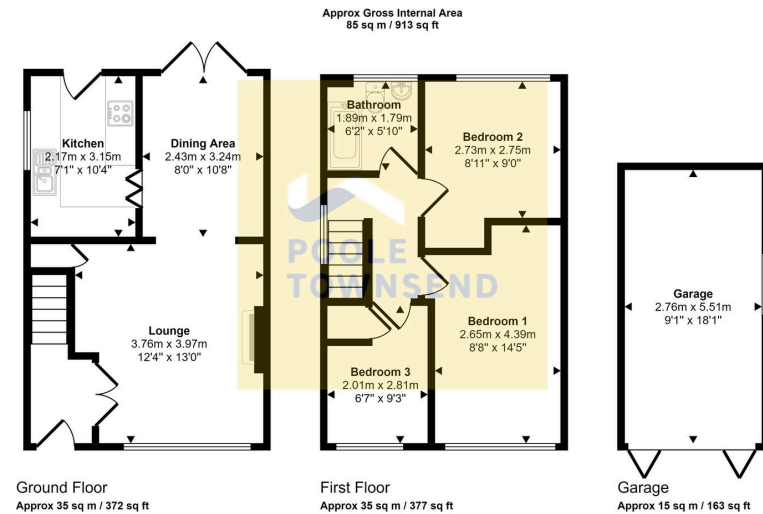

This floorplan is only for illustrative purposes and is not to scale. Measurements of rooms, doors, windows, and any items are approximate and no responsibility is taken for any error, omission or mis-statement. Icons of items such as bathroom suites are representations only and may not look like the real items. Made with Made Snappy 360.

NEW This nicely presented, family-sized home is located in the popular area of North Scale and is within an easy walk to the local bus route and to The Crown pub. The property offers open plan living with the lounge-dining room offering direct access into the rear garden and also into the separate fitted kitchen. The upstairs accommodation includes two double bedrooms, a single bedroom and a 3-piece bathroom with a shower fitted over the bath. There is garden to the front and rear plus driveway access to a detached garage.

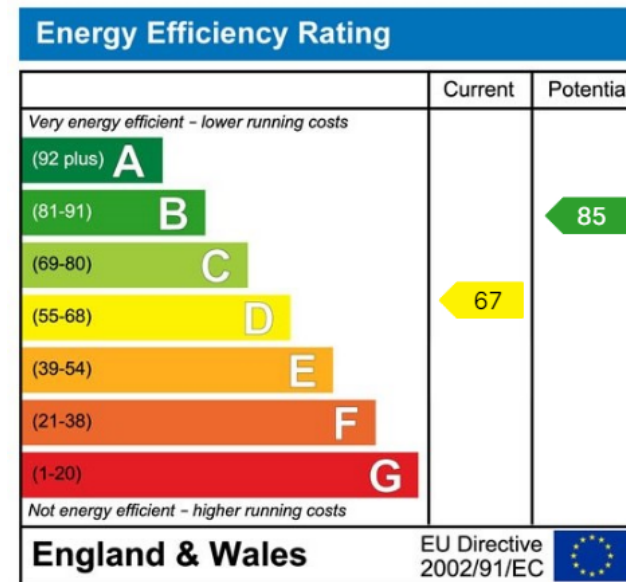

Visit us at
www.pooletownsend.co.uk
enquiries@pooletownsend.co.uk

We are open
 Monday – Friday 9.00 – 5.00
 Saturday 9.00 – 1.00

Barrow 01229 811811
 Ulverston 01229 588111
 Grange 015395 33316
 Kendal 01539 734455
 Milnthorpe 015395 62044