



**POOLE  
TOWNSEND**

# Sycamore Grove, BARROW-IN-FURNESS, LA14 5DX

£169,950

3 1 1



- Immaculately presented home
- Light and airy living space
- Smartly presented kitchen
- Three bedrooms
- Generous sized bathroom
- Garden to the front
- Patio to the rear
- Garage sized store building
- No upper chain
- Council tax band A





Approx Gross Internal Area  
63 sq m / 675 sq ft

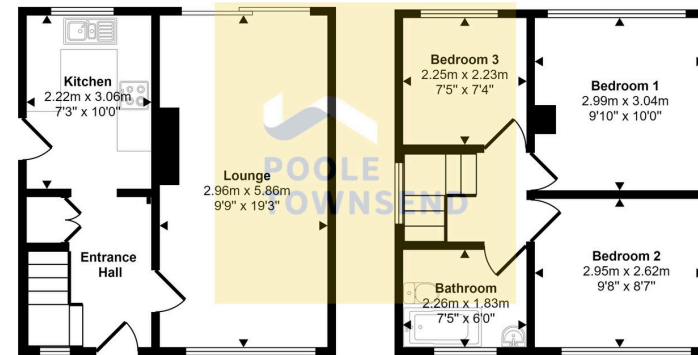

Ground Floor  
Approx 31 sq m / 335 sq ft

First Floor  
Approx 31 sq m / 339 sq ft

This floorplan is only for illustrative purposes and is not to scale. Measurements of rooms, doors, windows, and any items are approximate and no responsibility is taken for any error, omission or mis-statement. Icons of items such as bathroom suites are representations only and may not look like the real items. Made with Made Snappy 360.

NEW This is an immaculately presented home that has benefited from a recently completed renovation. The light and airy living space includes a dual aspect lounge with direct access to the garden, a smartly presented kitchen, three bedrooms and also a generous sized bathroom with a dual head shower fitting over the bath. There is an easy to manage garden to the front with artificial lawn and gravel borders plus a patio to the rear with a large gravel area alongside. There is a garage sized store building. No upper chain.

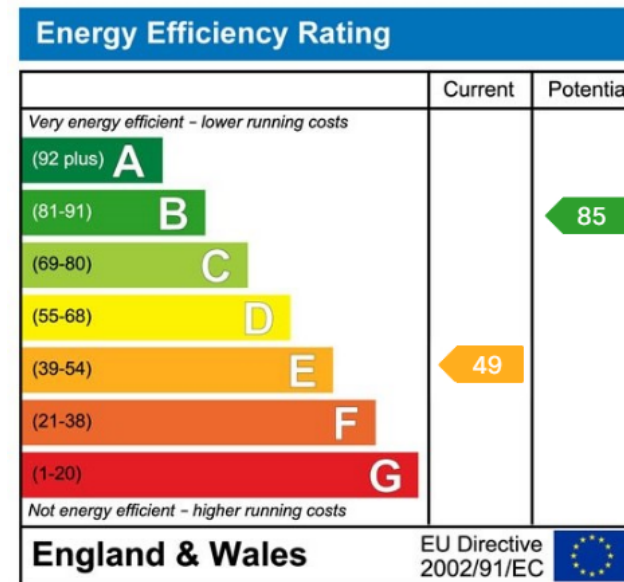

Visit us at  
[www.pooletownsend.co.uk](http://www.pooletownsend.co.uk)  
[enquiries@pooletownsend.co.uk](mailto:enquiries@pooletownsend.co.uk)

We are open  
 Monday – Friday 9.00 – 5.00  
 Saturday 9.00 – 1.00

Barrow 01229 811811  
 Ulverston 01229 588111  
 Grange 015395 33316  
 Kendal 01539 734455  
 Milnthorpe 015395 62044