



**POOLE
TOWNSEND**

Valley Drive, Barrow-In-Furness, LA13 9JG

£280,000

3 2 1



- Situated in a desirable location
- Fitted kitchen
- Private driveway
- Garage
- Double glazing
- 2 reception rooms
- Offers a more private feel from within
- Private driveway
- Gas-fired central heating system
- No upper chain



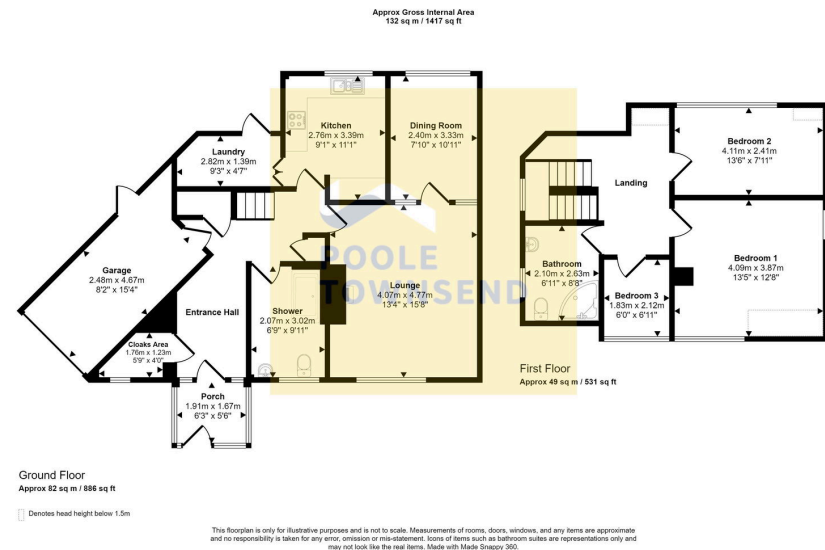

NEW This detached property is situated in a desirable location that is convenient for local sports facilities, schools, bus services and a Co-op store etc. The nicely proportioned, family sized accommodation features two reception rooms, a fitted kitchen with separate laundry space alongside, a GF shower room, a FF bathroom and three bedrooms. The slightly elevated position of the house offers a more private feel from within. There is plenty of opportunity for you to upgrade/decorate to your own personal taste and to perhaps re-instate the open plan arrangement of the kitchen and dining room by removing the stud partition wall that currently separates them. There is a private driveway, a garage and colourful garden to the front with further easy to manage hard standing to the rear. Additional features to note are the gas-fired central heating system, double glazing and no upper chain.

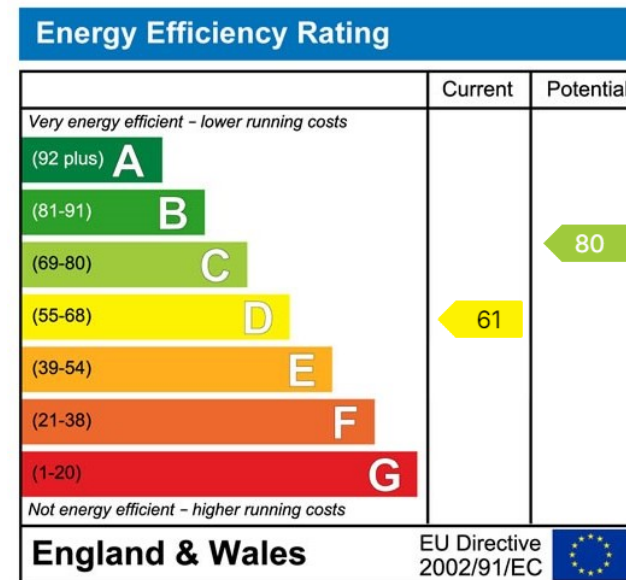

Visit us at
www.pooletownsend.co.uk
enquiries@pooletownsend.co.uk

We are open
 Monday – Friday 9.00 – 5.00
 Saturday 9.00 – 1.00

Barrow 01229 811811
 Ulverston 01229 588111
 Grange 015395 33316
 Kendal 01539 734455
 Milnthorpe 015395 62044