



**POOLE
TOWNSEND**

Sanderling Lane, Dalton-in-Furness , LA15 8QG

£249,950

3 1 0



- Immaculately presented bungalow
- lovely size lounge
- Fitted kitchen with appliances
- Three bedrooms
- 4-piece bathroom
- Driveway parking
- Open gravel covered garden to the front
- Colourful garden to the rear
- Vast loft space
- NO UPPER CHAIN



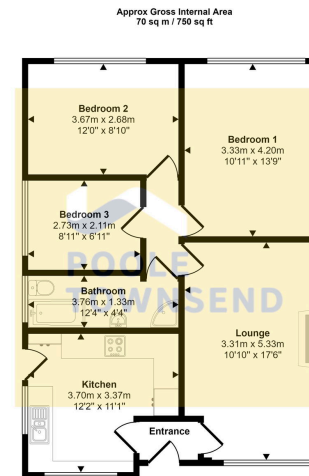

Floorplan

This floorplan is only for illustrative purposes and is not to scale. Measurements of rooms, doors, windows, and any items are approximate and no responsibility is taken for any error, omission or mis-statement. Icons of items such as bathroom suites are representations only and may not look like the real items. Made with Made Snappy 360.

PRICE REDUCTION This is an immaculately presented bungalow with no upper chain that has only recently been completed by the homeowners. The attractive decor and stylish fittings will appeal to all age ranges, couples and families. The popular location is just outside of the town centre, within a short walk to the local bus stop and train station. The bungalow features a lovely size lounge, fitted kitchen with appliances, three bedrooms and a 4-piece bathroom. There is driveway parking, open gravel covered garden to the front and a colourful garden to the rear. There is a vast loft space that could offer potential for conversion.

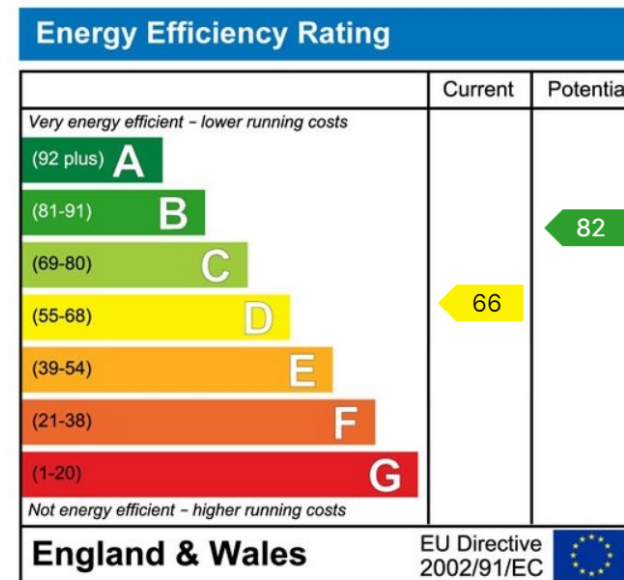

Visit us at
www.pooletownsend.co.uk
enquiries@pooletownsend.co.uk

We are open
 Monday – Friday 9.00 – 5.00
 Saturday 9.00 – 1.00

Barrow 01229 811811
 Ulverston 01229 588111
 Grange 015395 33316
 Kendal 01539 734455
 Milnthorpe 015395 62044