



**POOLE
TOWNSEND**

Smeaton Street, Barrow-in-furness, LA14 2EA

£82,000

🛏️ 2 🚿 1 🚗 2



- Attractively presented property
- Two reception rooms
- Two double bedrooms
- Gas-central heating system
- No upper chain
- Nicely laid out accommodation
- A modern kitchen
- Great size bathroom
- Double glazing



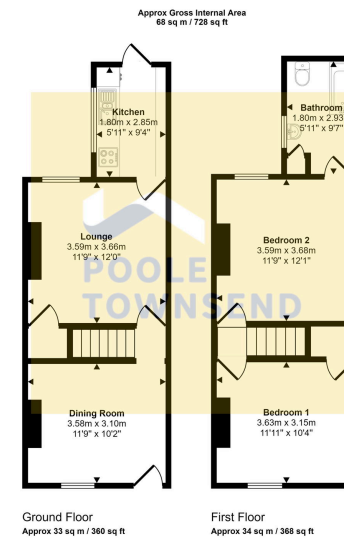

This floorplan is only for illustrative purposes and is not to scale. Measurements of rooms, doors, windows, and any items are approximate and no responsibility is taken for any error, omission or mis-statement. Icons of items such as bathroom suites are representations only and may not look like the real items. Made with Made Spraggy 360.

NEW This attractively presented property will appeal to younger buyers including first time purchasers, couples and landlords looking for a buy to-let investment. The accommodation is nicely laid out, featuring two reception rooms, a modern kitchen with integrated appliances, two double bedrooms and a great size bathroom that is accessed via the second bedroom. There is a gas central heating system, double glazing and no upper chain.

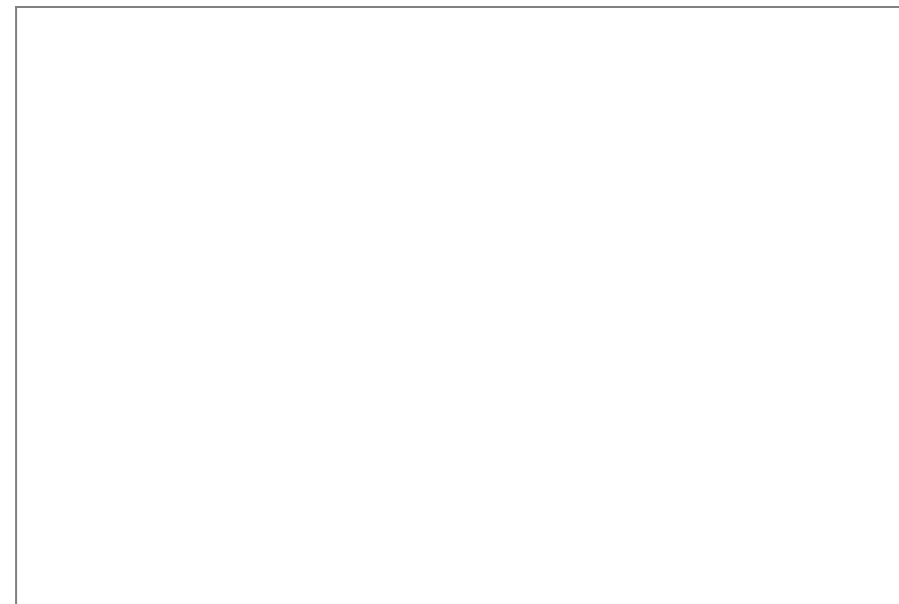

Visit us at
www.pooletownsend.co.uk
enquiries@pooletownsend.co.uk

We are open
 Monday – Friday 9.00 – 5.00
 Saturday 9.00 – 1.00

Barrow 01229 811811
 Ulverston 01229 588111
 Grange 015395 33316
 Kendal 01539 734455
 Milnthorpe 015395 62044