



**POOLE
TOWNSEND**

Vicarage Mount, Walney, Barrow-in-furness, LA14 3QX
£79,950

🛏️ 2 🪑 1 🚗 0



- Purpose-built apartment
- Offers extensive residents parking facilities
- Dual aspect lounge/dine
- Two bedrooms
- Double glazed
- Set within communal grounds
- Surprisingly well proportioned
- Fitted kitchen
- 3-piece bathroom
- No upper chain



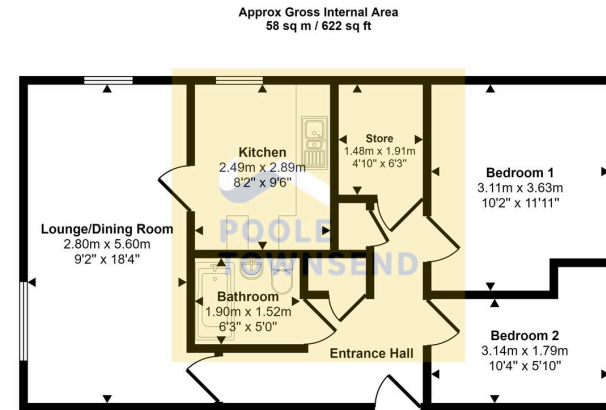

Floorplan

This floorplan is only for illustrative purposes and is not to scale. Measurements of rooms, doors, windows, and any items are approximate and no responsibility is taken for any error, omission or mis-statement. Icons of items such as bathroom suites are representations only and may not look like the real items. Made with Made Snappy 360.

NEW This purpose-built apartment occupies part of the first floor within the building that is set within communal grounds that also offers extensive residents parking facilities. The property is surprisingly well proportioned and offers extra security and convenience with a Telecom entry system. The inner hallway has two built-in cupboards and a walk-in store room, loft access and doors leading to all of the accommodation with exception the kitchen. There is a dual aspect lounge/diner, fitted kitchen, two bedrooms and a 3-piece bathroom. The windows are all double glazed and heating is provided by Rointe Kyros smart electric heaters. Residents parking and no upper chain.

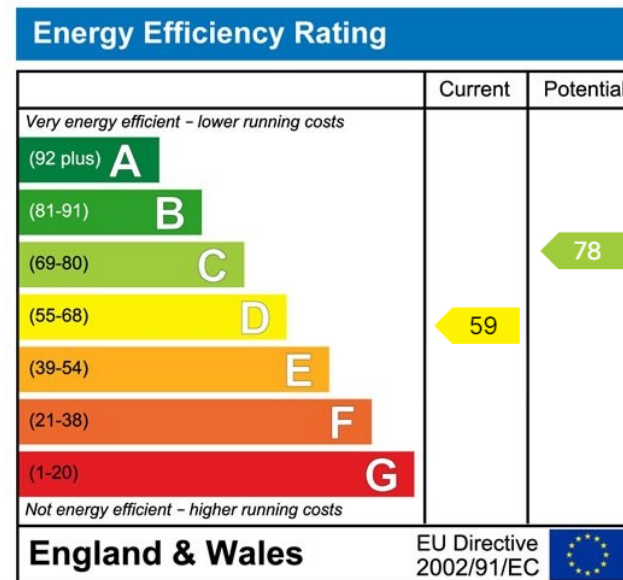

Visit us at
www.pooletownsend.co.uk
enquiries@pooletownsend.co.uk

We are open
 Monday – Friday 9.00 – 5.00
 Saturday 9.00 – 1.00

Barrow 01229 811811
 Ulverston 01229 588111
 Grange 015395 33316
 Kendal 01539 734455
 Milnthorpe 015395 62044