



**POOLE
TOWNSEND**

Greta Close, Barrow-In-Furness, LA14 3DN

£49,950

🛏️ 2 🚿 1 🚪 1



This modern built home will appeal to a whole host of buyers and will be suited to first time buyers, couples and small families. The accommodation includes a generous size lounge with sliding doors accessing the garden, a fitted kitchen, GF WC, 2 double bedrooms and a 3-piece bathroom. There are 2 allocated parking spaces, GCH and DG. Prospective buyers must be pre-approved by South Lakes Housing to qualify for a viewing and the opportunity to purchase this property. The asking price is to purchase 25% of the property with the remaining 75% to be held by South Lakes Housing. A monthly rental figure will be payable to South Lakes Housing as part of the leasehold.

Location

What3Words///part.unique.sound

Description

This property offers nicely designed accommodation, private enclosed garden and two allocated parking spaces.

The entrance hall leads to all of the ground floor accommodation including the 2-piece cloakroom/WC, kitchen and the lounge that overlooks the garden and also features a sliding door open onto the patio. This is a great size room that also benefits from having a useful under stair storage cupboard.

The smartly presented kitchen has a grey gloss finish to the fitted units, a laminate work surface and tiling to the walls. There is an integrated oven and hob, space for an upright fridge/freezer and plumbing for a washing machine. The boiler is concealed within the cupboard alongside the window.

The landing offers further built in storage, loft access and doors to the bathroom and the two double bedrooms.

The bathroom has a white suite with chrome coloured fittings including a mixer shower above the bath and a glazed screen alongside.





- Modern built home
- Appeal to many buyers
- Generous size lounge
- Purchasing 25% of the property
- Fitted kitchen
- 2 Double bedrooms
- South lakes owns 75%
- Leasehold agreement
- 2 Allocated parking spaces
- Ground floor WC

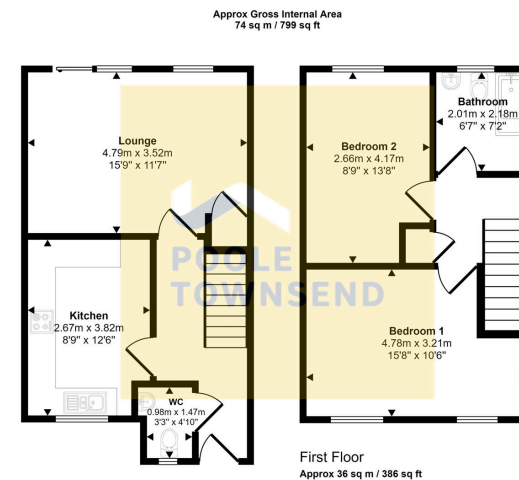

Ground Floor
Approx 38 sq m / 412 sq ft

This floorplan is only for illustrative purposes and is not to scale. Measurements of rooms, doors, windows, and any items are approximate and no responsibility is taken for any error, omission or mis-statement. Icons of items such as bathroom suites are representations only and may not look like the real items. Made with Made Snaggy 360.

Visit us at
www.pooletownsend.co.uk
enquiries@pooletownsend.co.uk

We are open
 Monday – Friday 9.00 – 5.00
 Saturday 9.00 – 1.00

Barrow 01229 811811
 Ulverston 01229 588111
 Grange 015395 33316
 Kendal 01539 734455
 Milnthorpe 015395 62044