



**POOLE  
TOWNSEND**

# Hempland Avenue, Barrow-in-furness, LA13 9EY

£145,000

3 1 1



- Terraced property
- Enclosed garden to the front and rear
- Nicely proportioned accommodation
- Family lounge
- Kitchen with separate laundry space
- Three bedrooms
- A wet room
- UPVC framed double glazing
- Gas fired central heating system
- Council tax band A



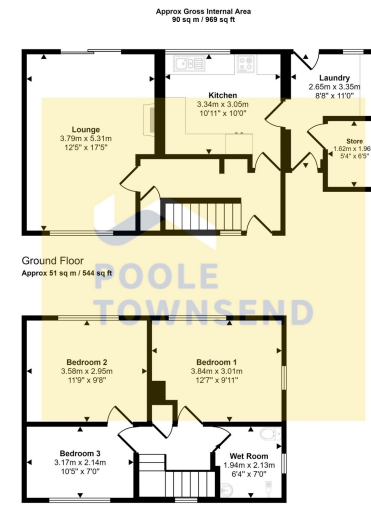

First Floor  
Approx 39 sq m / 425 sq ft

This floorplan is only for illustrative purposes and is not to scale. Measurements of rooms, doors, windows, and any items are approximate and no responsibility is taken for any error, omission or mis-statement. Items of items such as bathroom suites are representations only and may not look like the real items. Made with Make2Buy 360.

NEW This tree lined suburban road is in a popular part of the town that is sought after by first time buyers, couples and family buyers. The immediate area has a regular bus service, schools, convenience store and takeaway, leisure centre and doctors surgery. The property has enclosed garden to the front and rear and nicely proportioned accommodation that offers potential for further improvement. There is a family lounge with direct access into the garden, a kitchen and separate laundry space, three bedrooms and a wet room. There is UPVC framed double glazing and a gas-fired central heating system.

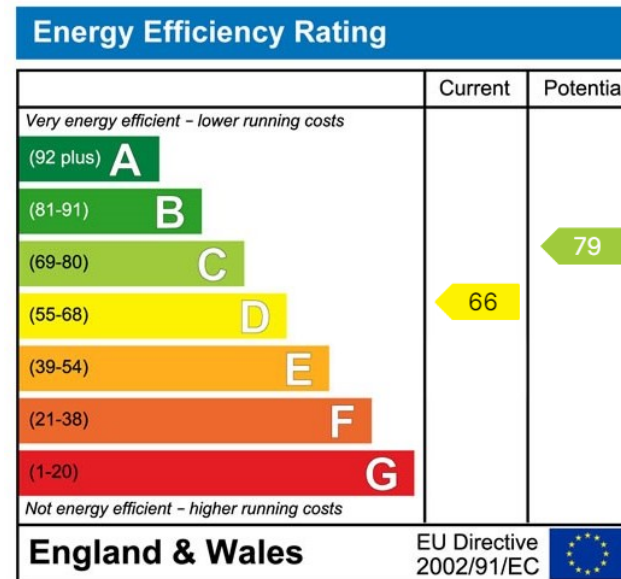

Visit us at  
[www.pooletownsend.co.uk](http://www.pooletownsend.co.uk)  
[enquiries@pooletownsend.co.uk](mailto:enquiries@pooletownsend.co.uk)

We are open  
 Monday – Friday 9.00 – 5.00  
 Saturday 9.00 – 1.00

Barrow 01229 811811  
 Ulverston 01229 588111  
 Grange 015395 33316  
 Kendal 01539 734455  
 Milnthorpe 015395 62044