



FOR SALE
POOLE TOWNSEND
01229 811811



POOLE TOWNSEND

Kentmere Crescent, Barrow-in-furness, LA14 4NL

£249,950

🛏️ 2 🚿 1 🚗 2



- Semi-detached bungalow
- Nicely appointed and extended acomodation
- Smartly presented lounge and fitted kitchen
- Dining/sitting room with access onto the patio
- Two bedrooms
- Double glazing throughout
- Gas-fired central heating system
- Extensive driveway parking
- Easy to manage garden space
- No upper chain



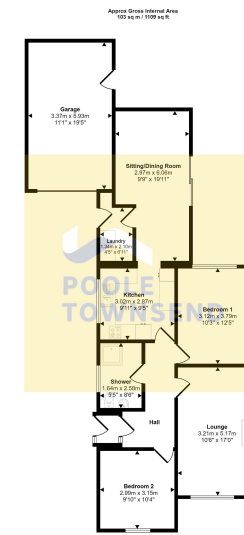

Floorplan
This floorplan is only for illustrative purposes and is not to scale. Measurements of rooms, doors, windows, and any items are approximate and no responsibility is taken for any errors or omissions. Items of furniture such as bathtubs, showers and appliances are representative only and may not be the same as the real items. Made with Make Energy 200.

NEW This semi-detached bungalow offers nicely appointed and extended accommodation, easy to manage garden space, extensive driveway parking and a larger than typical garage. The property is well presented and features a gas-fired central heating system and double glazing throughout, a smartly presented shower room, lounge, fitted kitchen, two bedrooms and a dining room/sitting room with access onto the patio and to an enclosed laundry space. No upper chain.

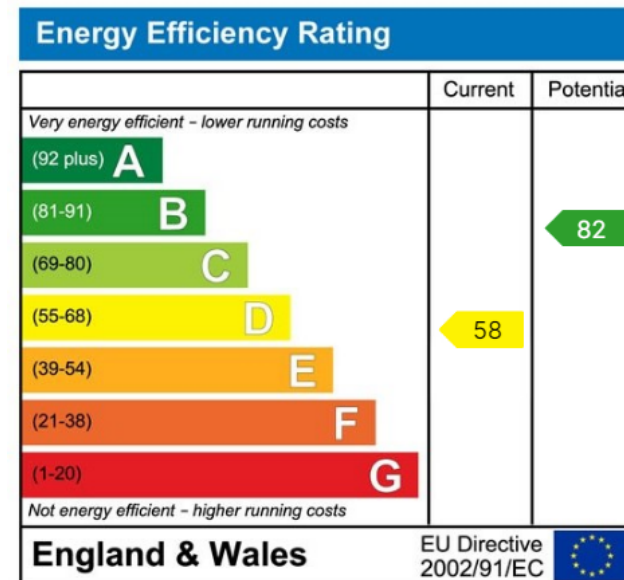

Visit us at
www.pooletownsend.co.uk
enquiries@pooletownsend.co.uk

We are open
 Monday – Friday 9.00 – 5.00
 Saturday 9.00 – 1.00

Barrow 01229 811811
 Ulverston 01229 588111
 Grange 015395 33316
 Kendal 01539 734455
 Milnthorpe 015395 62044