



**POOLE
TOWNSEND**

North Row, Barrow-In-Furness, LA13 0HG

£250,000

3 1 2



- Extensive Plot
- Appeal To All Buyers
- Open Plan Living
- Two Double Bedrooms
- Four Piece Bathroom
- Attached Garage
- Off Road Parking
- Gas, Central Heating
- Double Glazing
- No Upper Chain



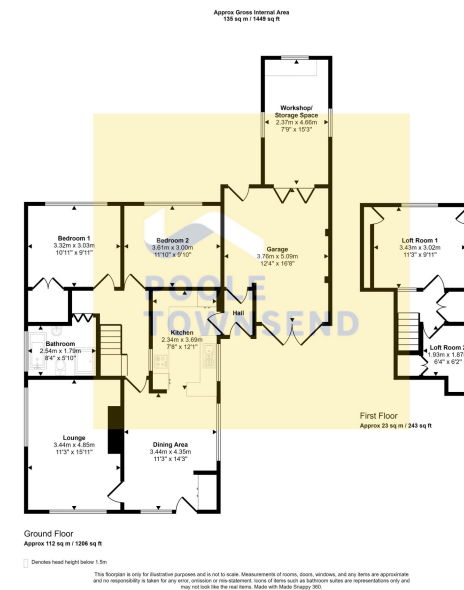

NEW This is a lovely sized bungalow that sits within an extensive plot with garden/land wrapping around all four sides of the property. The property could be improved further by upgrading and redecorating, something that may appeal to buyers who would like to add their personal taste. The accommodation briefly comprises; an open plan dining kitchen, dual aspect lounge, two double bedrooms and a modern four piece bathroom. There is a staircase ascending up to a small landing where there are two loft rooms. The attached garage offers extensive storage, workshop space and double doors for vehicular access. There is driveway parking, a gas central heating system and double glazing. No upper chain.

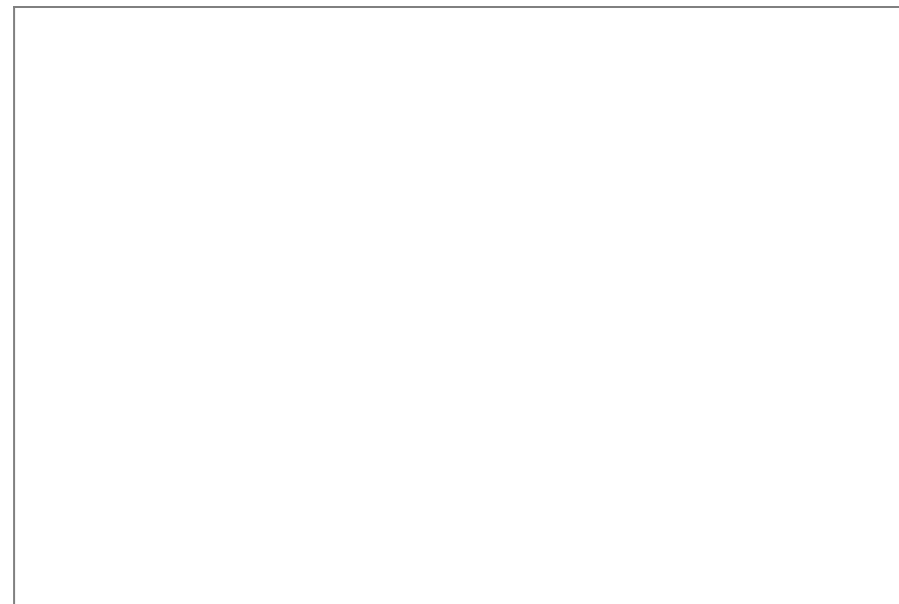

Visit us at
www.pooletownsend.co.uk
enquiries@pooletownsend.co.uk

We are open
 Monday – Friday 9.00 – 5.00
 Saturday 9.00 – 1.00

Barrow 01229 811811
 Ulverston 01229 588111
 Grange 015395 33316
 Kendal 01539 734455
 Milnthorpe 015395 62044